

## Town of Kiawah Island

### REQUEST FOR PROPOSALS TO INSTALL ELECTRIC VEHICLE CHARGING STATIONS AT THE TOWN OF KIAWAH MUNICIPAL COMPLEX

#### SECTION 1. PURPOSE

- 1.1.** The Town of Kiawah Island hereby requests proposals from qualified firms to install four (4) Blink Electric Vehicle (EV) charging stations for the Town of Kiawah Municipal Complex located at 4475 Betsy Kerrison Parkway, Kiawah Island, SC 29455

#### SECTION 2. PROJECT DESCRIPTION

The Town of Kiawah Island desires an approved company to expand the asphalt at the end of the employee lot to include curb and gutter (see Exhibit A) and to install the provided EV charging stations (see Exhibit B) at the Town's Municipal Center.

- 2.1.** The proposed work in this Request for Proposal (RFP) will include the following: installation drawings and schematics, line items of all materials, cost of civil asphalt work, EV charging signage with striping, bollards and foundation, project phases, and project timeline.

The Town will:

- A.** Supply the Blink Series 7+ Dual Port EV Chargers with the installation manual.

The contractor will:

- A.** Civil engineering and construction of parking space expansion.  
**B.** Connect charging infrastructure with our 200kw Cummins generator.  
**C.** Supply all materials and labor for the installation.  
**D.** Future proof by "make ready" for two additional dual port chargers in the other four parking spaces supplying and installing conduit and foundation.  
**E.** Provide 24-hour service and maintenance contracts for guaranteed uptime.

For questions or additional information, please contact Michael Nardelli, Assistant Operations Manager, by calling 843-806-8108 or by email at [mnardelli@kiawahisland.org](mailto:mnardelli@kiawahisland.org). No questions or requests will be accepted after February 19, 2024.

#### SECTION 3. RECEIPT OF PROPOSALS

- 3.1.** The proposals shall consist of One (1) printed copy and one (1) electronic copy of the Proposal (Submittal Form), which must be delivered on or before **2:00 PM EST on Friday, February 23, 2024**. Proposals must be submitted in a sealed envelope plainly marked "**EV Charging Station RFP**" and addressed to Petra Reynolds, Town Clerk, Town of Kiawah

Island, 4475 Betsy Kerrison Pkwy., Kiawah Island, SC 29455. Proposals can also be emailed to [preynolds@kiawahisland.org](mailto:preynolds@kiawahisland.org).

- 3.2.** Each proposal submitted will be the document upon which the Town of Kiawah Island will make its initial judgment regarding each proposer's qualifications, methodology, and ability to provide the requested services.
- 3.3.** Those submitting proposals do so entirely at their own expense. There is no expressed or implied obligation by the Town to reimburse any firm or individual for any costs incurred in preparing or submitting proposals, preparing or submitting additional information requested by the Town, or participating in any selection interviews.
- 3.4.** Submission of any proposal indicates an acceptance of the conditions contained in this Request for Proposals unless the submitted proposal clearly and specifically states otherwise.
- 3.5.** The Town of Kiawah Island reserves the right to accept or reject any and all proposals in whole or in part, to waive any and all informalities, and to disregard all non-conforming, non-responsive, or conditional proposals.
- 3.6.** The Town of Kiawah Island reserves the right to award the work, in whole or in part, to one or more firms and individuals.
- 3.7.** The Town of Kiawah Island reserves the right not to award any or all the work detailed in this document.
- 3.8.** Any award of the services shall be conditioned on the later execution of a formal written contract. The Town of Kiawah Island reserves the right to revoke or rescind any award at any time prior to the full execution of a formal written contract.

# EXHIBIT A

## Berkeley Electric Provided 3-Phase Power Map



## Approximate Asphalt Scope – 80 Feet in Width – Total of 8 New Parking Spaces

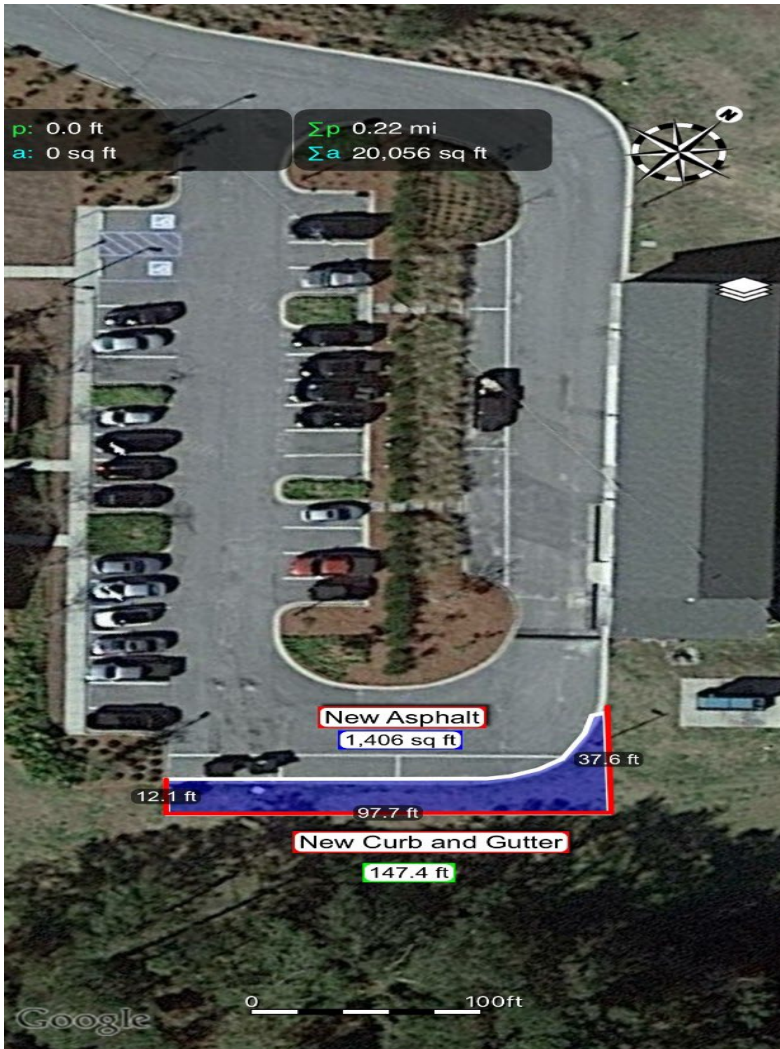



## Mapped Scope of Work



# Exhibit B



## INSTALLATION MANUAL Series 7, 7+, 8, 8+



## Table of Contents

|  |                  |
|--|------------------|
| <b><u>SAFETY AND COMPLIANCE.....</u></b>                             | <b><u>3</u></b>  |
| GENERAL.....   | 3                |
| STATEMENTS .....   | 4                |
| <b><u>SYSTEM REQUIREMENTS.....</u></b>                               | <b><u>4</u></b>  |
| GENERAL REQUIREMENTS.....  | 5                |
| ELECTRICAL REQUIREMENTS .....  | 6                |
| STATION CONNECTION DIAGRAMS .....                                    | 8                |
| COMMUNICATION REQUIREMENTS.....                                      | 9                |
| NETWORK PLATFORM REQUIREMENTS .....                                  | 9                |
| <b><u>HARDWARE INVENTORY SPECIFICATION AND INSTALLATION.....</u></b> | <b><u>10</u></b> |
| PEDESTAL MOUNT WITHOUT CABLE MANAGEMENT SYSTEM(CMS).....             | 10               |
| PEDESTAL MOUNT WITH CABLE MANAGEMENT SYSTEM (CMS).....               | 17               |
| WALL MOUNT WITHOUT CABLE MANAGEMENT SYSTEM (CMS).....                | 28               |
| WALL MOUNT WITH CABLE MANAGEMENT SYSTEM (CMS).....                   | 35               |
| <b><u>START-UP.....</u></b>  | <b><u>47</u></b> |

## SAFETY AND COMPLIANCE

This document provides instructions to install the Blink Charging Station and should not be used for any other products. This product must be installed in accordance with the National Electrical Code (NEC), the Canadian Electrical Code (CEC) or any applicable local code.

Review this manual and consult a licensed contractor and/or electrician before installation to ensure compliance with local building practices, climate conditions, safety standards, and state and local codes.

The Blink Charging Station should be installed by a licensed contractor/ electrician and inspected by a qualified installer prior to initial use. Under no circumstances will compliance with the information in this manual relieve the user of responsibility to comply with all applicable codes and safety standards.

This document describes the most common installation and mounting methods. Contact Blink where it is not possible to perform an installation using the procedures provided in this document.

Blink is not responsible for damages that may occur or result from installations that are not described in this document. This document is not offered as a formal design document. All designs for the installation of this product are the sole responsibility of the appropriately licensed and/or certified installing contractor.

The following signs are used throughout the installation manual following ANSI Z535 Standard

| Sign           | Intended Use   |
|----------------|--|
| <b>DANGER</b>  | <i>Situation will result in serious injury or death</i>  |
| <b>WARNING</b> | <i>Situation could result in serious injury or death</i>   |
| <b>CAUTION</b> | <i>Situation could result moderate or minor injury</i>   |
| <b>NOTICE</b>  | <i>Situations that at worst will only result in property damage and will not result in physical injuries</i> |

### **DANGER**

**Note: Make sure to TURN OFF all breakers before doing any electrical work!**

### General

The Blink Station is grounded through a dedicated conductor to the ground connection at the power distribution panel. This equipment has been tested and found to comply with the limits for a Class A digital device, pursuant to Part 15 of the FCC rules. These limits are designed to provide reasonable protection against harmful interference when the equipment is operated in a commercial environment.

### **CAUTION**

The equipment generates, uses, and can radiate radio frequency energy and, if not installed and used in accordance with the instruction manual, may cause harmful interference to radio communications.

## Statements

Reasonable effort has been made to ensure that the specifications and other information in this manual are accurate and complete at the time publication. However, specifications and other information in this manual are subject to change at any time without prior notice.

### NOTICE

Use of the Blink Charging Station in a manner not intended or any modification not approved by the manufacturer will void the limited warranty. Other than the limited product warranty provided by Blink, this manual and the Blink products are provided "AS IS," and Blink expressly disclaim all implied warranties, including any warranty of design, merchantability, and fitness for a particular purposes and non-infringement, to the maximum extent permitted by law.

### NOTICE

*IN NO EVENT SHALL BLINK OR ITS AUTHORIZED DISTRIBUTORS BE LIABLE FOR ANY INDIRECT, INCIDENTAL, SPECIAL, PUNITIVE, OR CONSEQUENTIAL DAMAGES, INCLUDING WITHOUT LIMITATION, LOST PROFITS, LOST DATA, LOSS OF USE, COST OF COVER, OR LOSS OR DAMAGE TO THE BLINK CHARGING STATION ARISING OUT OF OR RELATING TO THE USE OR INABILITY TO USE THIS MANUAL, OR RELATED PRODUCT, EVEN IF BLINK OR ITS AUTHORIZED DISTRIBUTORS HAVE BEEN ADVISED OF THE POSSIBILITY OF SUCH DAMAGES.*

All products or services mentioned are the trademarks, service marks, registered trademarks, or registered service marks of their respective owners. This material is protected by the copyright laws of the United States and other countries. It may not be modified, reproduced, or distributed without the prior, express written consent of Blink.



## SYSTEM REQUIREMENTS

### General Requirements

#### **⚠️ WARNING**

**Blink EV charging stations require a solidly grounded electrical system with the presence of a main bonding jumper or system bonding jumper. Ungrounded sources or impedance grounded sources of any type (resistor/reactor) are not suitable for Blink EV charging stations.**

**Blink EV charging stations require 240 volt (phase to phase) or 208 volt (phase to phase) input with an equipment grounding conductor. A grounded conductor (neutral conductor) is not required. All breakers must be non-GFCI breakers.**

Anchoring detail is the responsibility of others. Anchoring must be capable of minimum weight and height in accordance with the provided table. Any seismic, wind-loading and/or snow-loading considerations increasing weights or wind-profile of unit will be the responsibility of others.

|  | WEIGHT<br>(LBS) | HEIGHT<br>(INCHES) |
|--|-----------------|--------------------|
| SERIES 7 - 18' OUTPUT CABLES             | 36              | 20.5               |
| SERIES 7 - 25' OUTPUT CABLES             | 41              | 20.5               |
| SERIES 8 - 18' OUTPUT CABLES             | 36              | 24                 |
| SERIES 8 - 25' OUTPUT CABLES             | 41              | 24                 |
| SERIES 7+ - 18' OUTPUT CABLES            | 36              | 20.5               |
| SERIES 7+ - 25' OUTPUT CABLES            | 41              | 20.5               |
| SERIES 8+ - 18' OUTPUT CABLES            | 36              | 24                 |
| SERIES 8+ - 25' OUTPUT CABLES            | 41              | 24                 |
| SERIES 7, 7+, 8, 8+ PEDESTAL             | 7.7             | 37.4               |
| SERIES 7, 7+, 8, 8+ Wall Mount Bracket   | 7.7             | 18.1               |
| SERIES 7, 8 CABLE MANAGEMENT SYSTEM      | 75.5            | 70.6               |
| SERIES 7+, 8+ 80 CABLE MANAGEMENT SYSTEM | 86.6            | 70.6               |

## Electrical Requirements

### **⚠️ WARNING**

Each Blink EV charging station is listed and labeled through Nationally Recognized Testing Laboratory compliance testing at the maximum or 'full rated' output. Each station is capable of continuous full rated output up to its labeled rating or modified default output configurations in accordance with the following tables:

SERIES 7+/8+ 80 AMP - DUAL SOURCE INPUT CONFIGURATION

| SERIES 7+/8+ (80 AMPS)           |                       |  |                 |
|----------------------------------|-----------------------|--|-----------------|
| 240 V or 208 V DUAL SOURCE INPUT | TWO-POLE BREAKER SIZE | MODIFIED OUTPUT CONFIGURATION REQUIRED | AMPERAGE OUTPUT |
|                                  | 100A                  | NO                                     | 80A             |
|                                  | 90A                   | YES                                    | 72A             |
|                                  | 80A                   | YES                                    | 64A             |
|                                  | 70A                   | YES                                    | 56A             |
|                                  | 60A                   | YES                                    | 48A             |
|                                  | 50A                   | YES                                    | 40A             |
|                                  | 40A                   | YES                                    | 32A             |
|                                  | 30A                   | YES                                    | 24A             |
|                                  | 20A                   | YES                                    | 16A             |
|                                  | 15A                   | YES                                    | 12A             |

SERIES 7/8 48 AMP - DUAL SOURCE INPUT CONFIGURATION

| SERIES 7/8 (48 AMPS)             |                       |  |                 |
|----------------------------------|-----------------------|--|-----------------|
| 240 V or 208 V DUAL SOURCE INPUT | TWO-POLE BREAKER SIZE | MODIFIED OUTPUT CONFIGURATION REQUIRED | AMPERAGE OUTPUT |
|                                  | 60A                   | NO                                     | 48A             |
|                                  | 50A                   | YES                                    | 40A             |
|                                  | 40A                   | YES                                    | 32A             |
|                                  | 30A                   | YES                                    | 24A             |
|                                  | 20A                   | YES                                    | 16A             |
|                                  | 15A                   | YES                                    | 12A             |

SERIES 7/8 30 AMP - DUAL SOURCE INPUT CONFIGURATION

| SERIES 7/8 (30 AMPS)             |                       |  |                 |
|----------------------------------|-----------------------|--|-----------------|
| 240 V or 208 V DUAL SOURCE INPUT | TWO-POLE BREAKER SIZE | MODIFIED OUTPUT CONFIGURATION REQUIRED | AMPERAGE OUTPUT |
|                                  | 40A                   | NO                                     | 30A             |
|                                  | 30A                   | YES                                    | 24A             |
|                                  | 20A                   | YES                                    | 16A             |
| 15A                              | YES                   | 12A                                    |                 |

SERIES 7+/8+ 80 AMP - SINGLE SOURCE INPUT CONFIGURATION

**MODIFIED OUTPUT CONFIGURATION OR LOAD MANAGEMENT REQUIRED**

| SERIES 7+/8+ (80 AMPS)           |                       |   |                 |
|----------------------------------|-----------------------|---|-----------------|
| 240V or 208V SINGLE SOURCE INPUT | TWO-POLE BREAKER SIZE | MODIFIED OUTPUT CONFIGURATION OR LOAD MANAGEMENT REQUIRED | AMPERAGE OUTPUT |
|                                  | 100A                  | YES   | 80A             |
|                                  | 90A                   | YES   | 72A             |
|                                  | 80A                   | YES   | 64A             |
|                                  | 70A                   | YES   | 56A             |
|                                  | 60A                   | YES   | 48A             |
|                                  | 50A                   | YES   | 40A             |
|                                  | 40A                   | YES   | 32A             |
|                                  | 30A                   | YES   | 24A             |
|                                  | 20A                   | YES   | 16A             |
| 15A                              | YES                   | 12A   |                 |

SERIES 7/8 48 AMP - SINGLE SOURCE INPUT CONFIGURATION

**MODIFIED OUTPUT CONFIGURATION OR LOAD MANAGEMENT REQUIRED**

| SERIES 7/8 (48 AMPS)             |                       |   |                 |
|----------------------------------|-----------------------|---|-----------------|
| 240V or 208V SINGLE SOURCE INPUT | TWO-POLE BREAKER SIZE | MODIFIED OUTPUT CONFIGURATION OR LOAD MANAGEMENT REQUIRED | AMPERAGE OUTPUT |
|                                  | 60A                   | YES   | 48A             |
|                                  | 50A                   | YES   | 40A             |
|                                  | 40A                   | YES   | 32A             |
|                                  | 30A                   | YES   | 24A             |
|                                  | 20A                   | YES   | 16A             |
| 15A                              | YES                   | 12A   |                 |

SERIES 7/8 30 AMP - SINGLE SOURCE INPUT CONFIGURATION

**MODIFIED OUTPUT CONFIGURATION OR LOAD MANAGEMENT REQUIRED**

| SERIES 7/8 (30 AMPS)             |                       |   |                 |
|----------------------------------|-----------------------|---|-----------------|
| 240V or 208V SINGLE SOURCE INPUT | TWO-POLE BREAKER SIZE | MODIFIED OUTPUT CONFIGURATION OR LOAD MANAGEMENT REQUIRED | AMPERAGE OUTPUT |
|                                  | 40A                   | YES   | 30A             |
|                                  | 30A                   | YES   | 24A             |
|                                  | 20A                   | YES   | 16A             |
| 15A                              | YES                   | 12A   |                 |

## Station Connection Diagrams

**⚠ WARNING**

### DUAL SOURCE INPUT

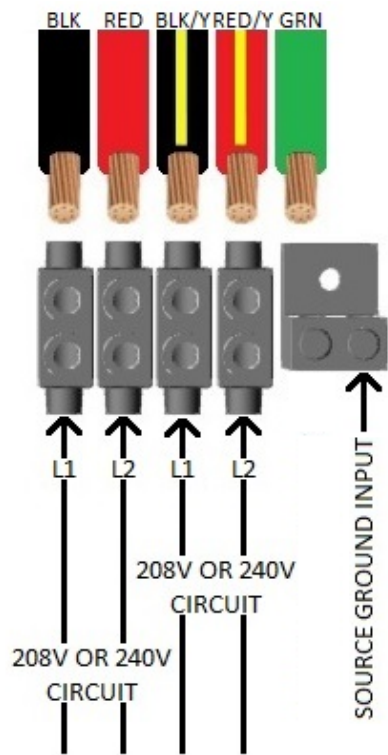

### SINGLE SOURCE INPUT

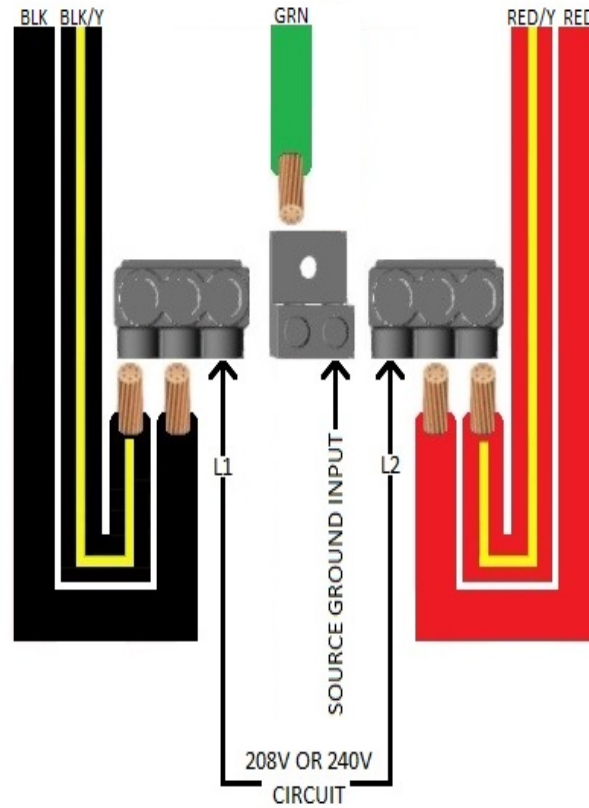

## Communication Requirements

Blink EV charging stations require cellular connectivity to function properly. To enable cellular connectivity, please reference the following cellular carriers and minimum operational signal requirement at each Blink EV charging station location:

|         |        |                             |                               |
|---------|--------|-----------------------------|-------------------------------|
| Verizon | 4G LTE | Band 13                     | RSRP: -95 dBm<br>RSRQ: -13 dB |
|         |        | Band 4                      |                               |
| ATT     | 4G LTE | Band 2<br>Band 5<br>Band 12 | RSRP: -95 dBm<br>RSRQ: -13 dB |

Blink stations do not use 5G cellular or Wi-Fi communication protocols.

## Network Platform Requirements

### NOTICE

To enable modified output configurations or load management configurations, Blink must be notified during station Start-up/enrollment. Failure to do so may result in nuisance breaker tripping and/or system damage. Refer to Start Up section of this manual for details.



## HARDWARE INVENTORY SPECIFICATION AND INSTALLATION

### Pedestal Mount without Cable Management System (CMS)



**Series 7/7+**

**Series 8/8+**

## Pedestal Mount Inventory Specification

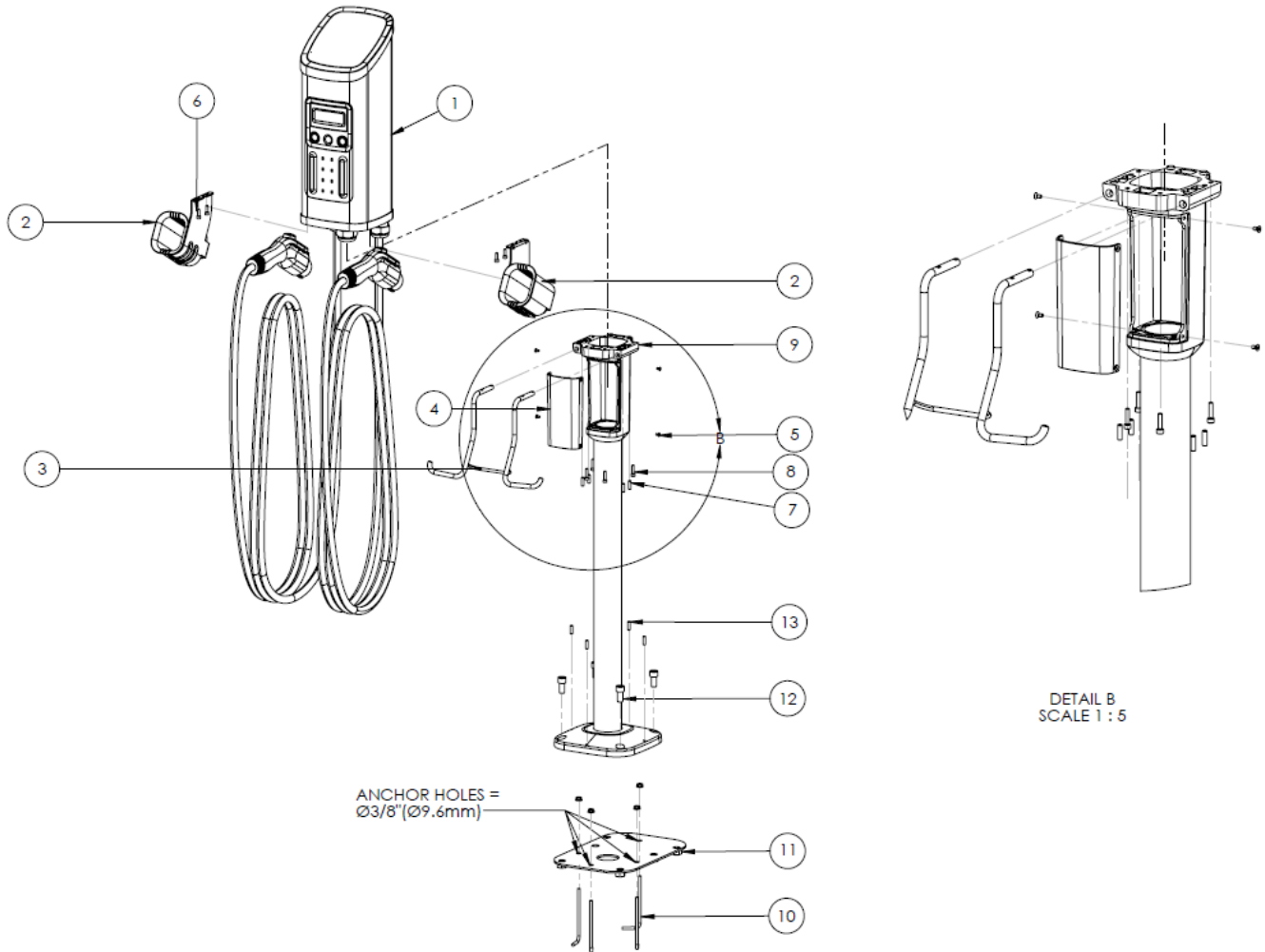

| SL. NO | DESCRIPTION  | QTY | TOOL REQUIRED            |
|--------|--|-----|--------------------------|
| 01     | HEAD UNIT ASSEMBLY                                 | 01  | -                        |
| 02     | HOLSTER ASSEMBLY                                   | 02  | -                        |
| 03     | CABLE RACK   | 01  | -                        |
| 04     | ACCESS PANEL COVER                                 | 01  | -                        |
| 05     | ACCESS PANEL SCREWS - M4 X 10mm                    | 04  | 2.5mm ALLEN KEY          |
| 06     | HOLSTER MOUNTING SCREWS - M5 X 10mm                | 04  | 4mm X 8" SHANK ALLEN KEY |
| 07     | CABLE RACK SCREWS - M4 X 6mm                       | 04  | 2mm ALLEN KEY            |
| 08     | HEAD UNIT MOUNTING SCREWS - M5 X 20mm              | 04  | 4mm ALLEN KEY            |
| 09     | PEDESTAL ASSEMBLY                                  | 01  | -                        |
| 10     | ANCHOR PENETRATIONS (ANCHORING PROVIDED BY OTHERS) | 04  | -                        |
| 11     | ANCHOR PLATE                                       | 01  | -                        |
| 12     | PEDESTAL MOUNTING SCREWS - M12 X 25mm              | 04  | 10mm ALLEN KEY           |
| 13     | GROUND LEVELING SCREWS - M8 X 8mm                  | 04  | 3mm ALLEN KEY            |

## 1. INSTALL ANCHOR PLATE

### **⚠ WARNING**

**VERIFY ALL CONDUCTORS ARE DE-ENERGIZED**

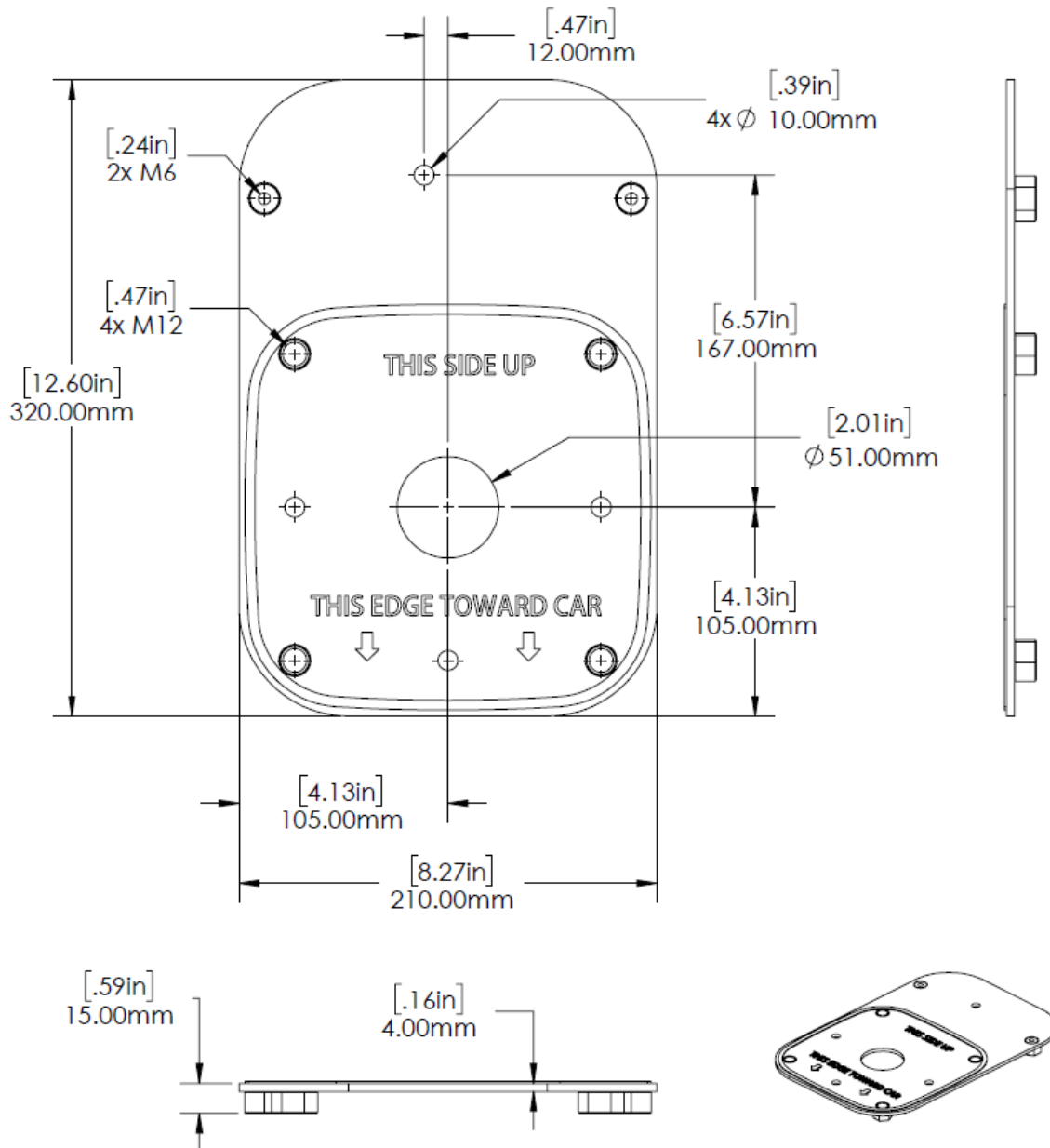

## 2. REMOVE ACCESS PANEL COVER AND INSTALL PEDESTAL WITH ACCESS PLATE OPENING FORWARD-FACING

### **⚠ WARNING**

VERIFY ALL CONDUCTORS ARE DE-ENERGIZED

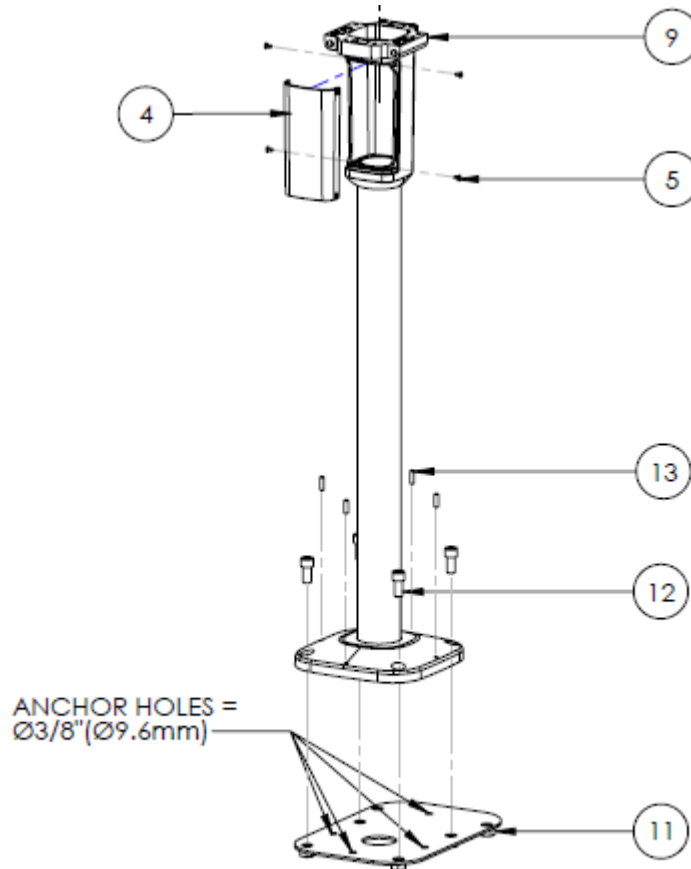

| SL. NO | DESCRIPTION                           | QTY | TOOL REQUIRED   |
|--------|---------------------------------------|-----|-----------------|
| 04     | ACCESS PANEL COVER                    | 01  | -               |
| 05     | ACCESS PANEL SCREWS - M4 X 10mm       | 04  | 2.5mm ALLEN KEY |
| 09     | PEDESTAL ASSEMBLY                     | 01  | -               |
| 11     | ANCHOR PLATE                          | 01  | -               |
| 12     | PEDESTAL MOUNTING SCREWS - M12 X 25mm | 04  | 10mm ALLEN KEY  |
| 13     | GROUND LEVELING SCREWS - M8 X 8mm     | 04  | 3mm ALLEN KEY   |

### 3. INSTALL CHARGING HEAD UNIT

## ⚠ CAUTION

Refer to General Requirements section for station weights

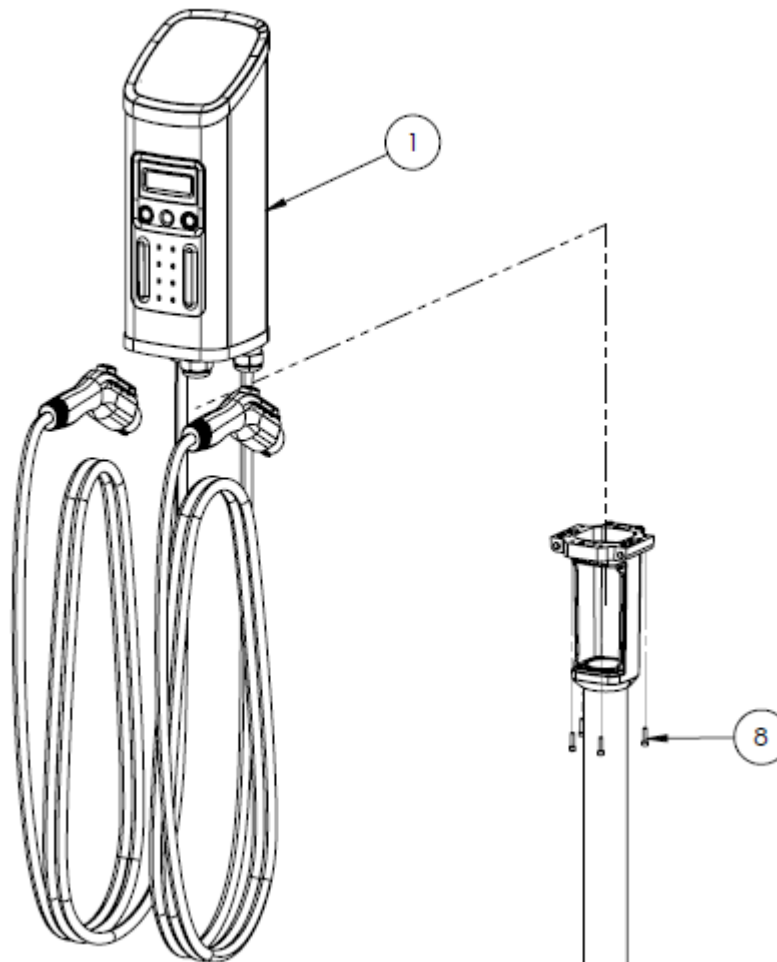

| SL. NO | DESCRIPTION                           | QTY | TOOL REQUIRED |
|--------|---------------------------------------|-----|---------------|
| 01     | HEAD UNIT ASSEMBLY                    | 01  | -             |
| 08     | HEAD UNIT MOUNTING SCREWS - M5 X 20mm | 04  | 4mm ALLEN KEY |

## ⚠ WARNING

**VERIFY ALL CONDUCTORS ARE DE-ENERGIZED. COMPLETE ALL ELECTRICAL CONNECTIONS PRIOR TO STEP 4. SEE SYSTEM REQUIREMENTS SECTION FOR CONNECTION DETAILS.**

RE-INSTALL ACCESS PANEL COVER UPON COMPLETION OF ELECTRICAL CONNECTIONS.



## 4. INSTALL CABLE RACK

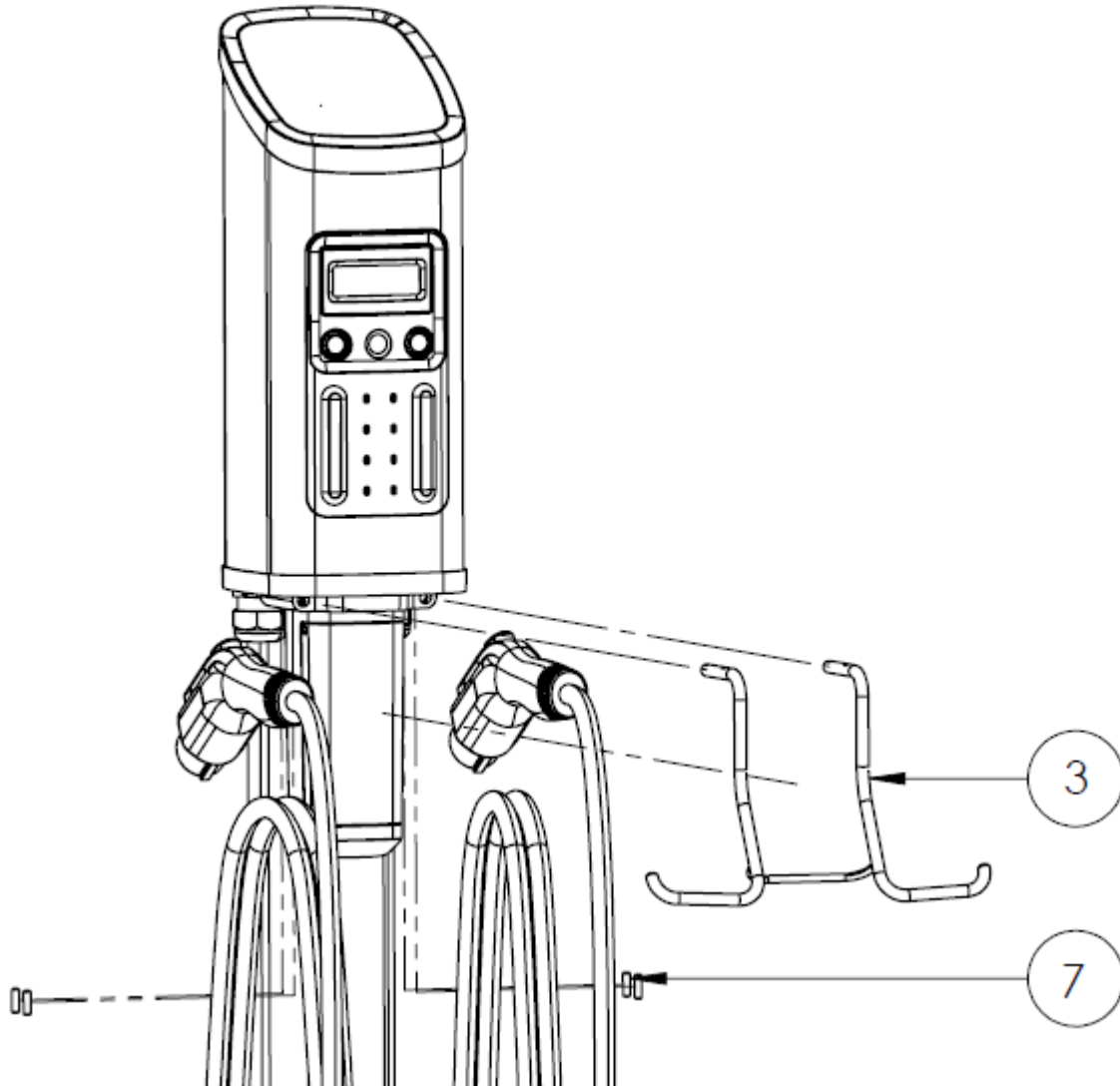

| SL. NO | DESCRIPTION                  | QTY | TOOL REQUIRED |
|--------|------------------------------|-----|---------------|
| 03     | CABLE RACK                   | 01  | -             |
| 07     | CABLE RACK SCREWS - M4 X 6mm | 04  | 2mm ALLEN KEY |

## 5. INSTALL CABLE HOLSTERS

**Note: A 8" (200 MM) SHANK, 4 MM ALLEN WRENCH IS REQUIRED TO ATTACH THE CABLE HOLSTERS TO THE CHARGING STATION.**

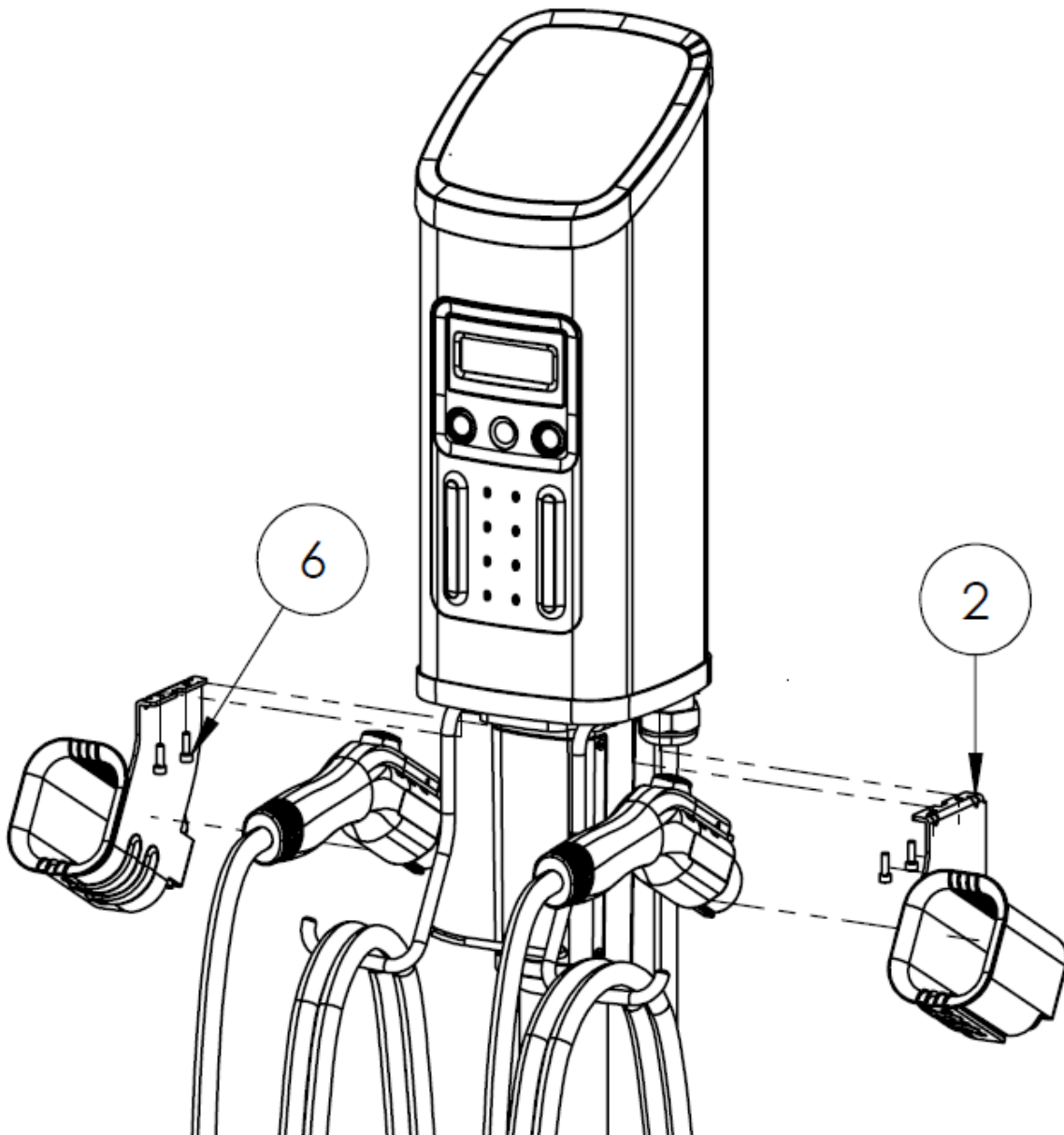

| SL. NO | DESCRIPTION                         | QTY | TOOL REQUIRED            |
|--------|-------------------------------------|-----|--------------------------|
| 02     | HOLSTER ASSEMBLY                    | 02  | -                        |
| 06     | HOLSTER MOUNTING SCREWS - M5 X 10mm | 04  | 4mm X 8" SHANK ALLEN KEY |

## Pedestal Mount with Cable Management System (CMS)



**Series 7/7+**

**Series 8/8+**

## Pedestal Mount with Cable Management System Inventory Specification

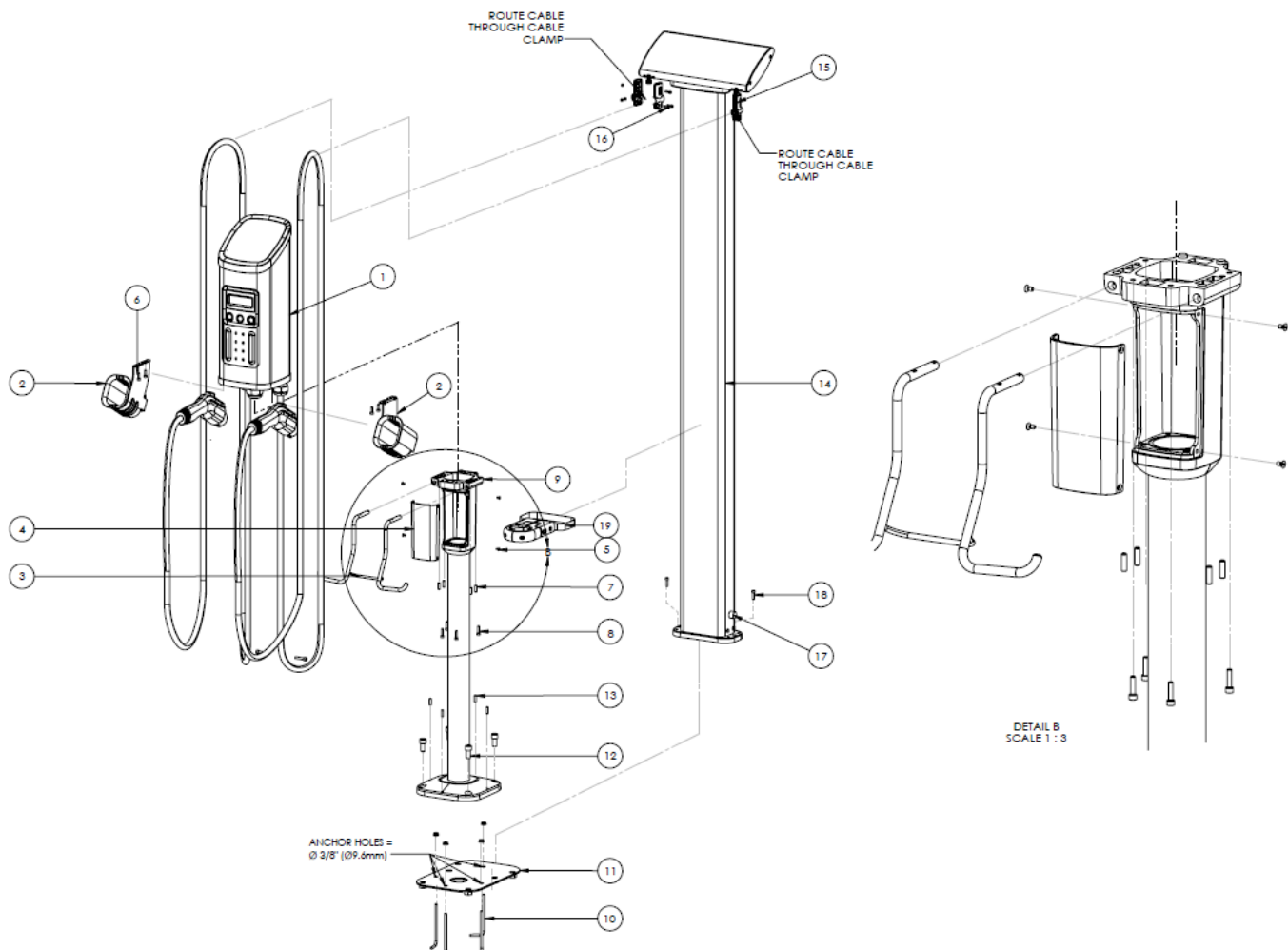

| SL. NO | DESCRIPTION  | QTY | TOOL REQUIRED            |
|--------|--|-----|--------------------------|
| 01     | HEAD UNIT ASSEMBLY   | 01  | -                        |
| 02     | HOLSTER ASSEMBLY   | 02  | -                        |
| 03     | CABLE RACK   | 01  | -                        |
| 04     | ACCESS PANEL COVER   | 01  | -                        |
| 05     | ACCESS PANEL SCREWS - M4 X 10mm                                    | 04  | 2.5mm ALLEN KEY          |
| 06     | HOLSTER MOUNTING SCREWS - M5 X 10mm                                | 04  | 4mm X 8" SHANK ALLEN KEY |
| 07     | CABLE RACK SCREWS - M4 X 6mm                                       | 04  | 2mm ALLEN KEY            |
| 08     | HEAD UNIT MOUNTING SCREWS - M5 X 20mm                              | 04  | 4mm ALLEN KEY            |
| 09     | PEDESTAL ASSEMBLY  | 01  | -                        |
| 10     | ANCHOR PENETRATIONS (ANCHORING PROVIDED BY OTHERS)                 | 04  | -                        |
| 11     | ANCHOR PLATE   | 01  | -                        |
| 12     | PEDESTAL MOUNTING SCREWS - M12 X 25mm                              | 04  | 10mm ALLEN KEY           |
| 13     | GROUND LEVELING SCREWS - M8 X 8mm                                  | 04  | 3mm ALLEN KEY            |
| 14     | CABLE MANAGEMENT SYSTEM ASSEMBLY                                   | 01  | -                        |
| 15     | OUTPUT CABLE CLAMPS  | 02  | -                        |
| 16     | OUTPUT CABLE CLAMP SCREWS - M4 X 10mm, M4 X 16mm, M4 X 20mm        |     | 3mm ALLEN KEY            |
| 17     | CABLE MANAGEMENT SYSTEM COUNTER WEIGHT RETENSION BOLTS - M6 X 30mm | 02  | 5mm ALLEN KEY            |
| 18     | CABLE MANAGEMENT SYSTEM MOUNTING SCREWS - M6 X 25mm                | 02  | 5mm ALLEN KEY            |
| 19     | CABLE MANAGEMENT SYSTEM SUPPORT STRAP                              | 01  | 3mm & 5mm ALLEN KEY      |

## 1. INSTALL ANCHOR PLATE

### **⚠️ WARNING**

**VERIFY ALL CONDUCTORS ARE DE-ENERGIZED**

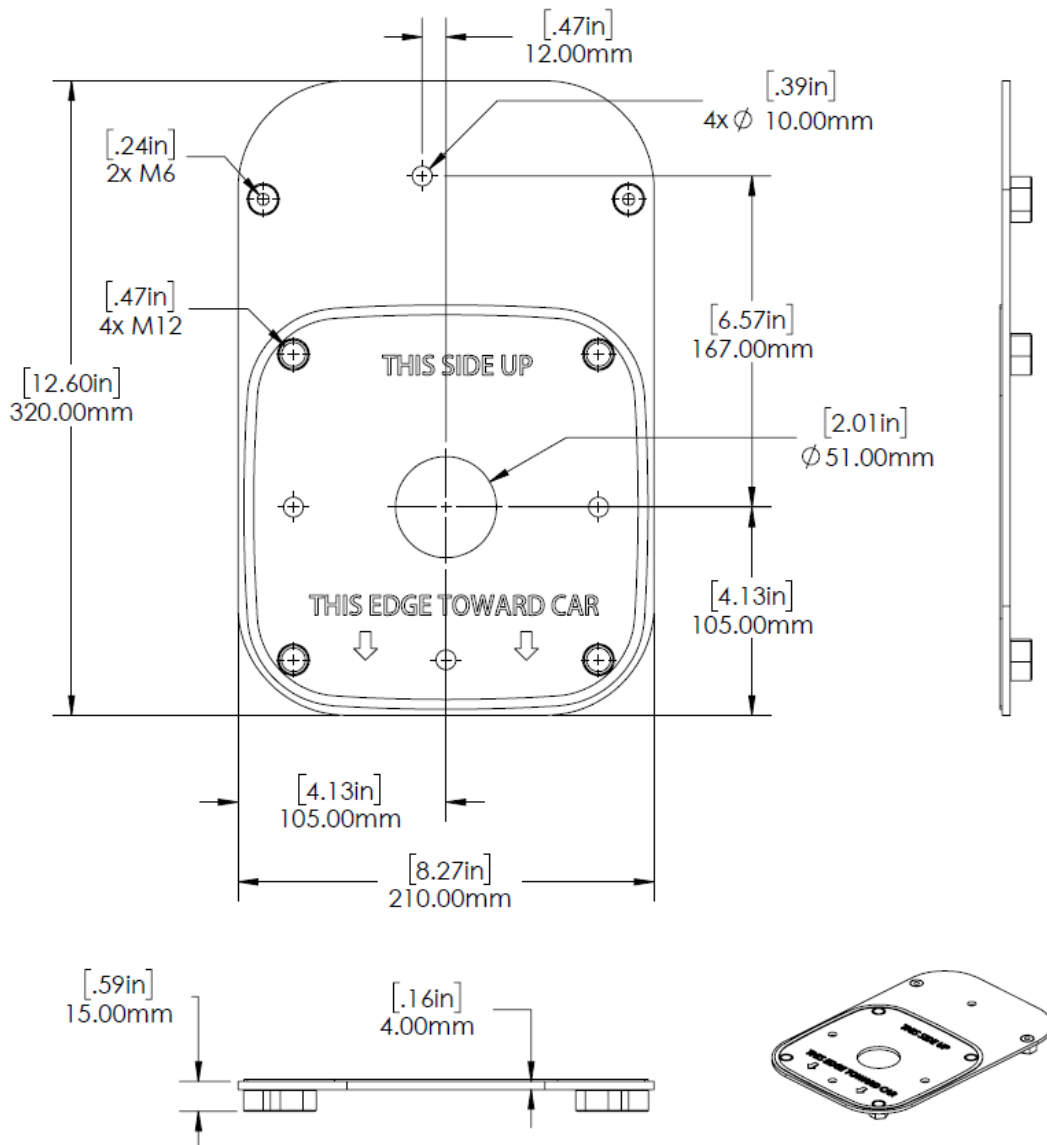



## 2. REMOVE ACCESS PANEL COVER AND INSTALL PEDESTAL WITH ACCESS PLATE OPENING FORWARD FACING

### **⚠ WARNING**

**VERIFY ALL CONDUCTORS ARE DE-ENERGIZED**

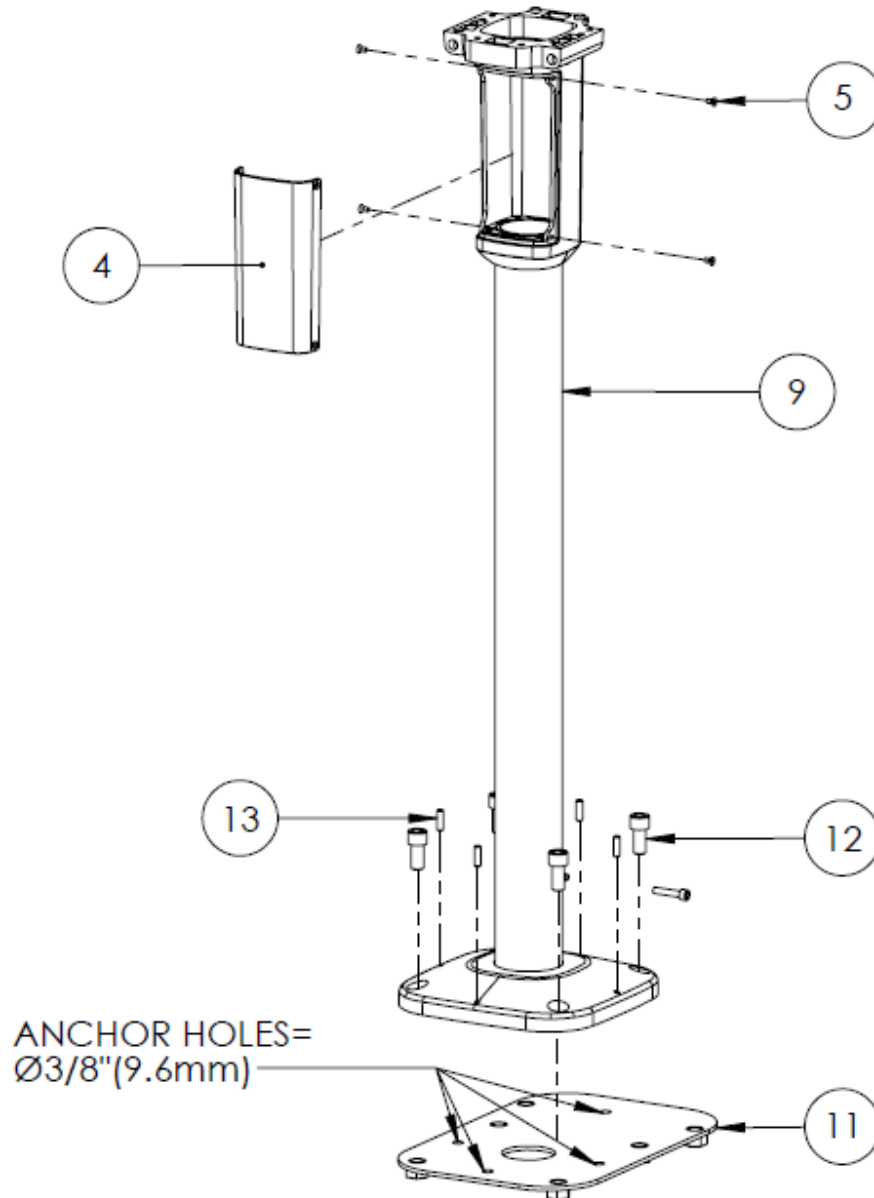

| SL. NO | DESCRIPTION                           | QTY | TOOL REQUIRED   |
|--------|---------------------------------------|-----|-----------------|
| 04     | ACCESS PANEL COVER                    | 01  | -               |
| 05     | ACCESS PANEL SCREWS - M4 X 10mm       | 04  | 2.5mm ALLEN KEY |
| 09     | PEDESTAL ASSEMBLY                     | 01  | -               |
| 11     | ANCHOR PLATE                          | 01  | -               |
| 12     | PEDESTAL MOUNTING SCREWS - M12 X 25mm | 04  | 10mm ALLEN KEY  |
| 13     | GROUND LEVELING SCREWS - M8 X 8mm     | 04  | 3mm ALLEN KEY   |

### 3. INSTALL CHARGING HEAD UNIT

## ⚠ CAUTION

Refer to General Requirements section for station weights

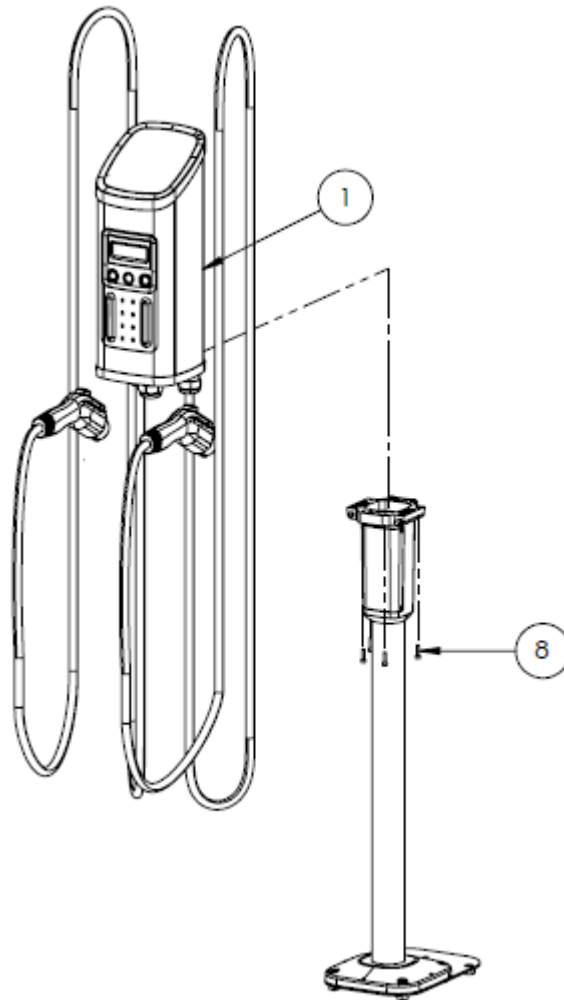

| SL. NO | DESCRIPTION                           | QTY | TOOL REQUIRED |
|--------|---------------------------------------|-----|---------------|
| 01     | HEAD UNIT ASSEMBLY                    | 01  | -             |
| 08     | HEAD UNIT MOUNTING SCREWS - M5 X 20mm | 04  | 4mm ALLEN KEY |

## ⚠ WARNING

**VERIFY ALL CONDUCTORS ARE DE-ENERGIZED. COMPLETE ALL ELECTRICAL CONNECTIONS PRIOR TO STEP 4. SEE SYSTEM REQUIREMENTS SECTION FOR CONNECTION DETAILS.**

RE-INSTALL ACCESS PANEL COVER UPON COMPLETION OF ELECTRICAL CONNECTIONS.

## 4. INSTALL CABLE RACK (CABLE RACK OPTIONAL WITH CABLE MANAGEMENT SYSTEM)

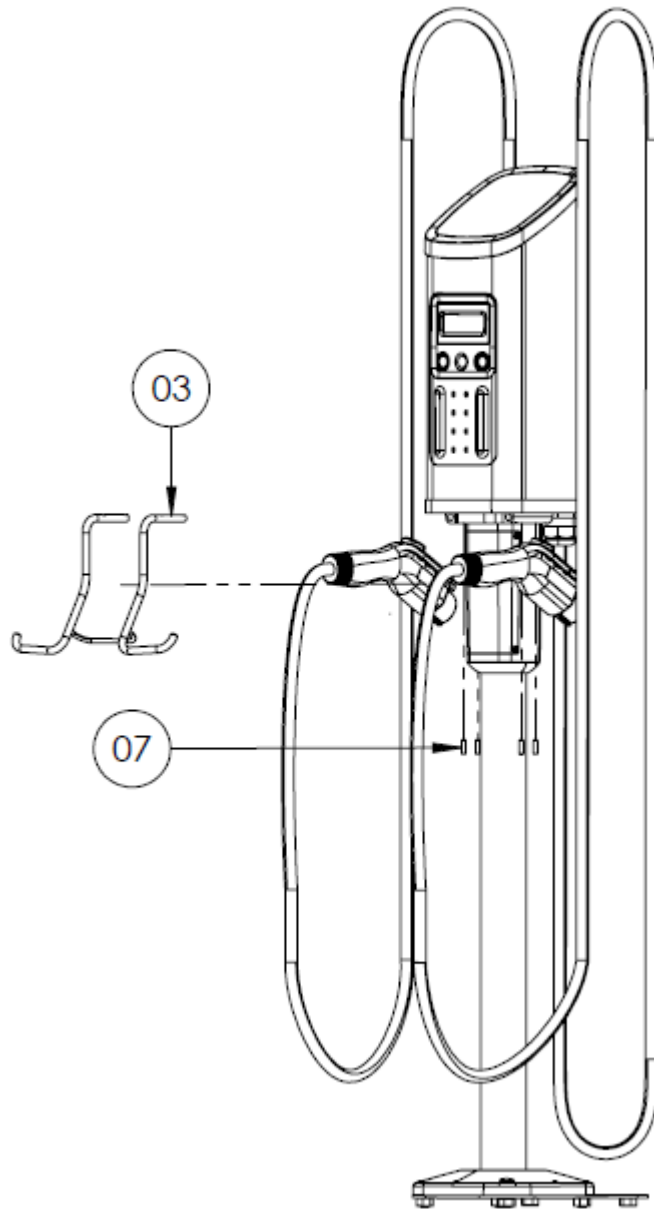

| SL. NO | DESCRIPTION                  | QTY | TOOL REQUIRED |
|--------|------------------------------|-----|---------------|
| 03     | CABLE RACK                   | 01  | -             |
| 07     | CABLE RACK SCREWS - M4 X 6mm | 04  | 2mm ALLEN KEY |

## 5. INSTALL CABLE HOLSTERS

**Note: A 8" (200 MM) SHANK, 4 MM ALLEN WRENCH IS REQUIRED TO ATTACH THE CABLE HOLSTERS TO THE CHARGING STATION**

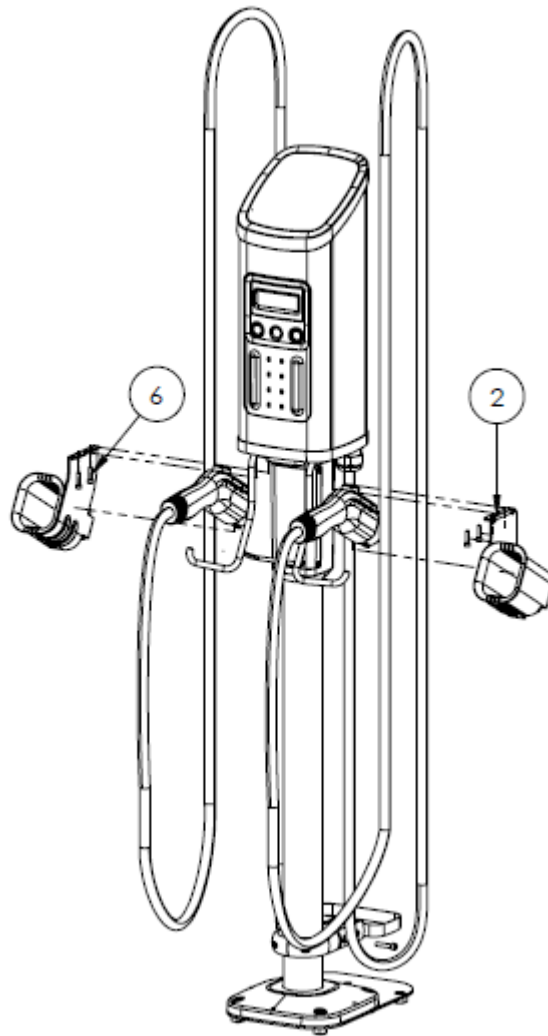

| SL. NO | DESCRIPTION                         | QTY | TOOL REQUIRED            |
|--------|-------------------------------------|-----|--------------------------|
| 02     | HOLSTER ASSEMBLY                    | 02  | -                        |
| 06     | HOLSTER MOUNTING SCREWS - M5 X 10mm | 04  | 4mm X 8" SHANK ALLEN KEY |

## 6. INSTALL CABLE MANAGEMENT SYSTEM (CMS)

### **⚠ CAUTION**

Refer to General Requirements section for Cable Management System Weights

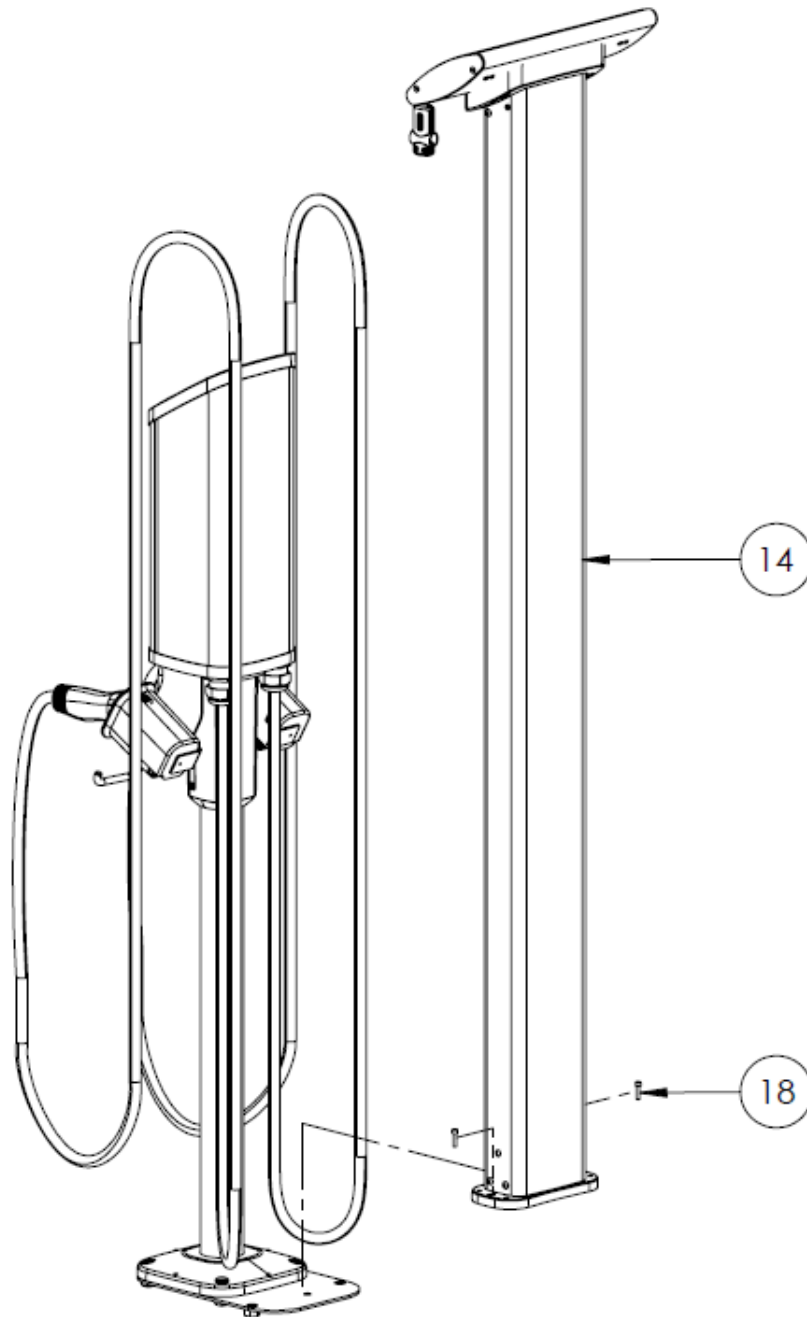

| SL. NO | DESCRIPTION   | QTY | TOOL REQUIRED |
|--------|---|-----|---------------|
| 14     | CABLE MANAGEMENT SYSTEM ASSEMBLY                    | 01  | -             |
| 18     | CABLE MANAGEMENT SYSTEM MOUNTING SCREWS - M6 X 25mm | 02  | 5mm ALLEN KEY |



## 7. INSTALL CMS PEDESTAL CLAMP

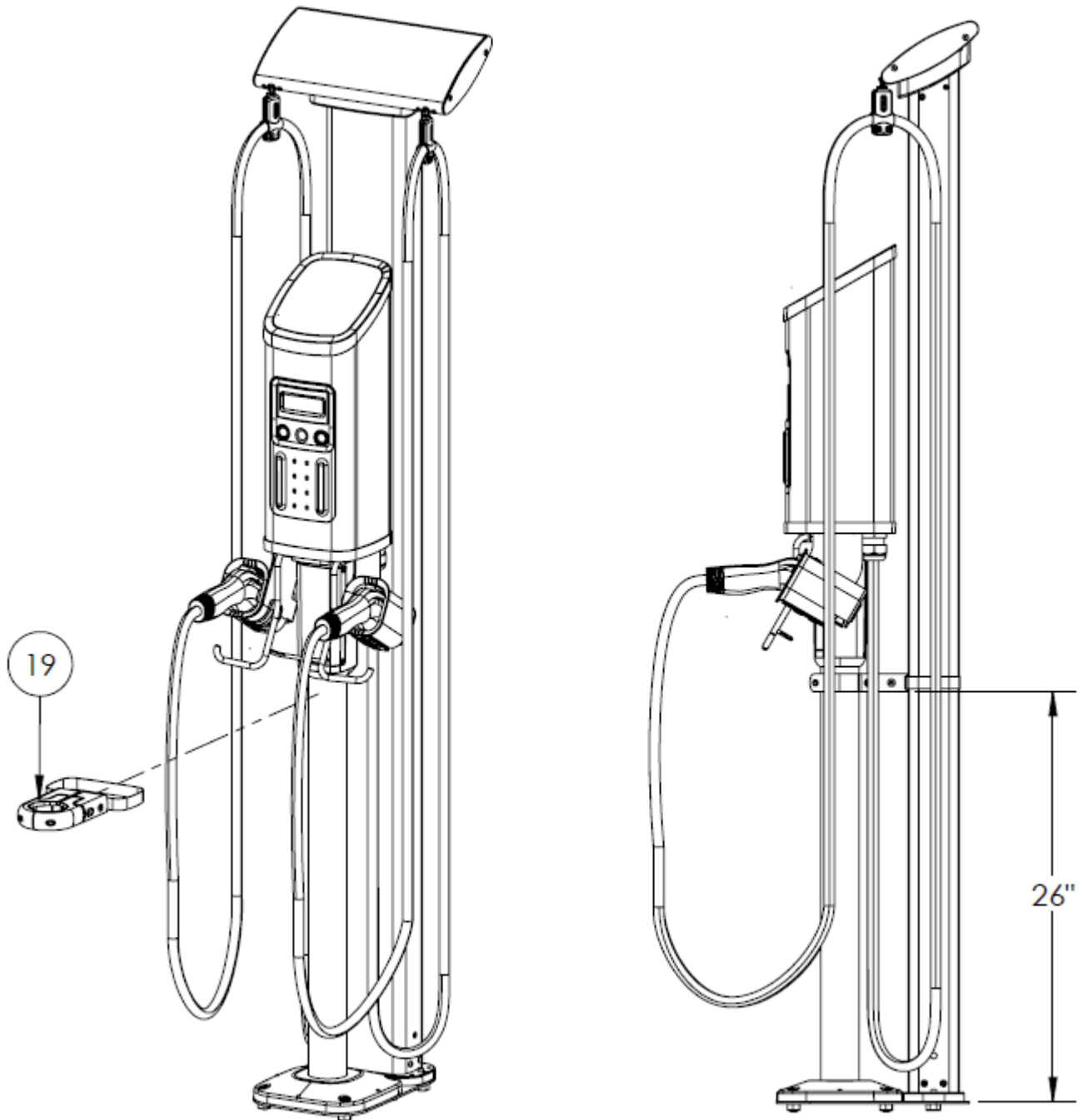

| SL. NO | DESCRIPTION                           | QTY | TOOL REQUIRED       |
|--------|---------------------------------------|-----|---------------------|
| 19     | CABLE MANAGEMENT SYSTEM SUPPORT STRAP | 01  | 3mm & 5mm ALLEN KEY |

## 8. INSTALL CABLE MANAGEMENT SYSTEM OUTPUT CABLE CLAMPS

### 30A/48A Cable Clamp

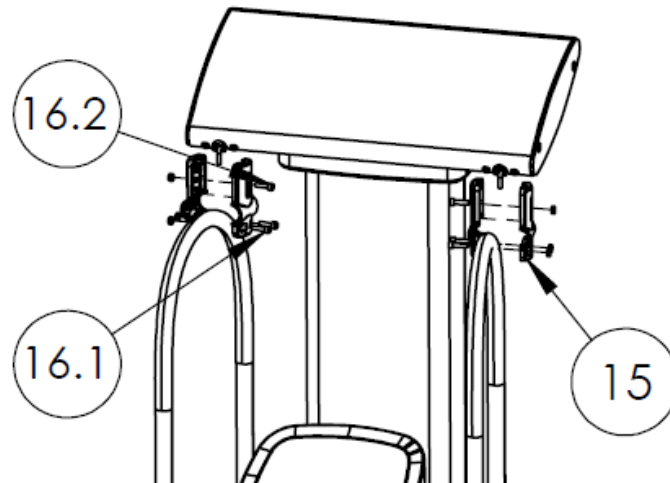

### 80A Cable Clamp

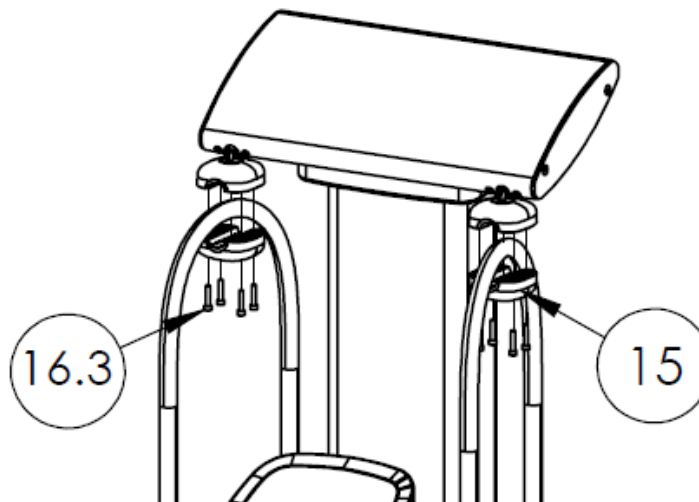

**18' Cable** - Install clamp 9' from the output cable J1772 coupler

**25' Cable** - Install clamp 9' from the output cable J1772 coupler

| SL. NO | DESCRIPTION                           | QTY | TOOL REQUIRED |
|--------|---------------------------------------|-----|---------------|
| 15     | OUTPUT CABLE CLAMPS                   | 02  | -             |
| 16.1   | OUTPUT CABLE CLAMP SCREWS - M4 X 10mm | 04  | 3mm ALLEN KEY |
| 16.2   | OUTPUT CABLE CLAMP SCREWS - M4 X 16mm | 02  | 3mm ALLEN KEY |
| 16.3   | OUTPUT CABLE CLAMP SCREWS - M4 X 20mm | 08  | 3mm ALLEN KEY |

## 9. REMOVE CMS COUNTERWEIGHT RETENTION BOLTS

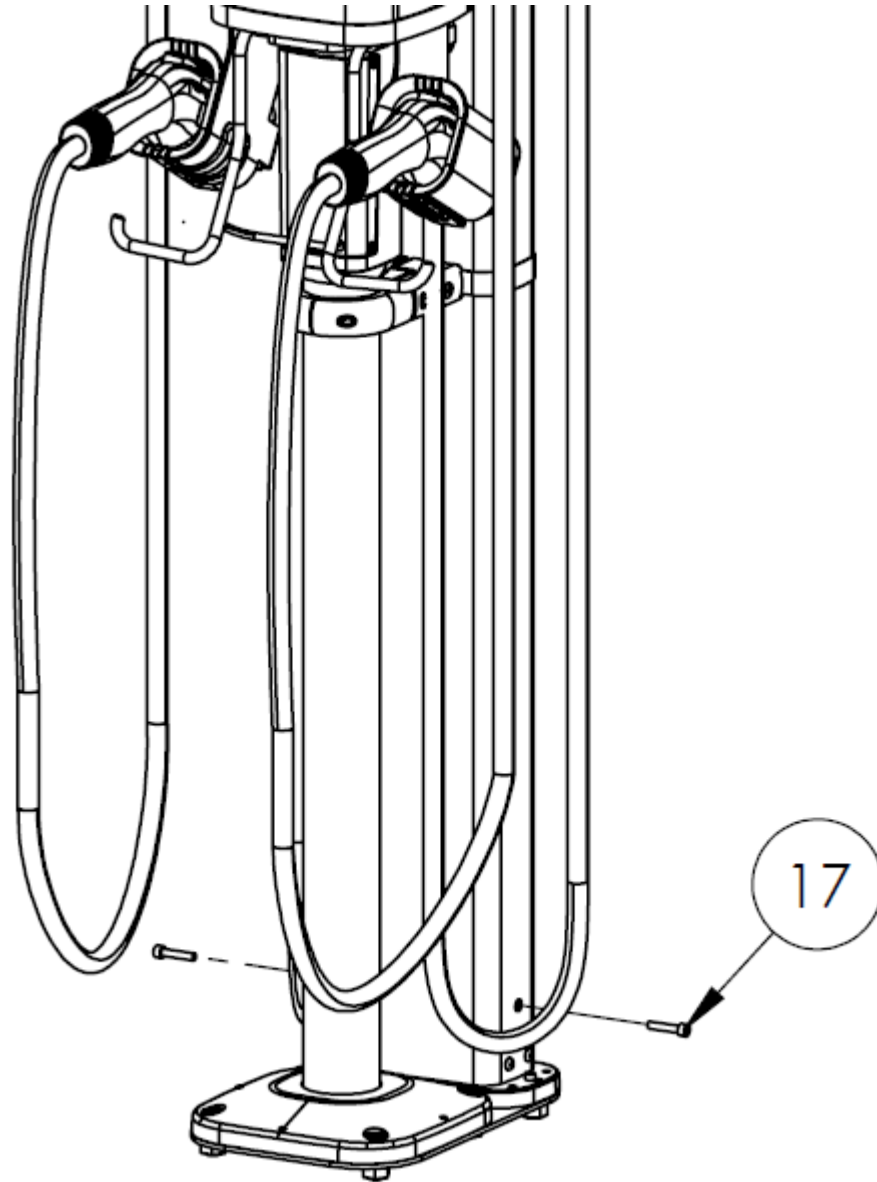

| SL. NO | DESCRIPTION  | QTY | TOOL REQUIRED |
|--------|--|-----|---------------|
| 17     | CABLE MANAGEMENT SYSTEM COUNTER WEIGHT RETENSION BOLTS - M6 X 30mm | 02  | 5mm ALLEN KEY |

## Wall Mount Without Cable Management System (CMS)

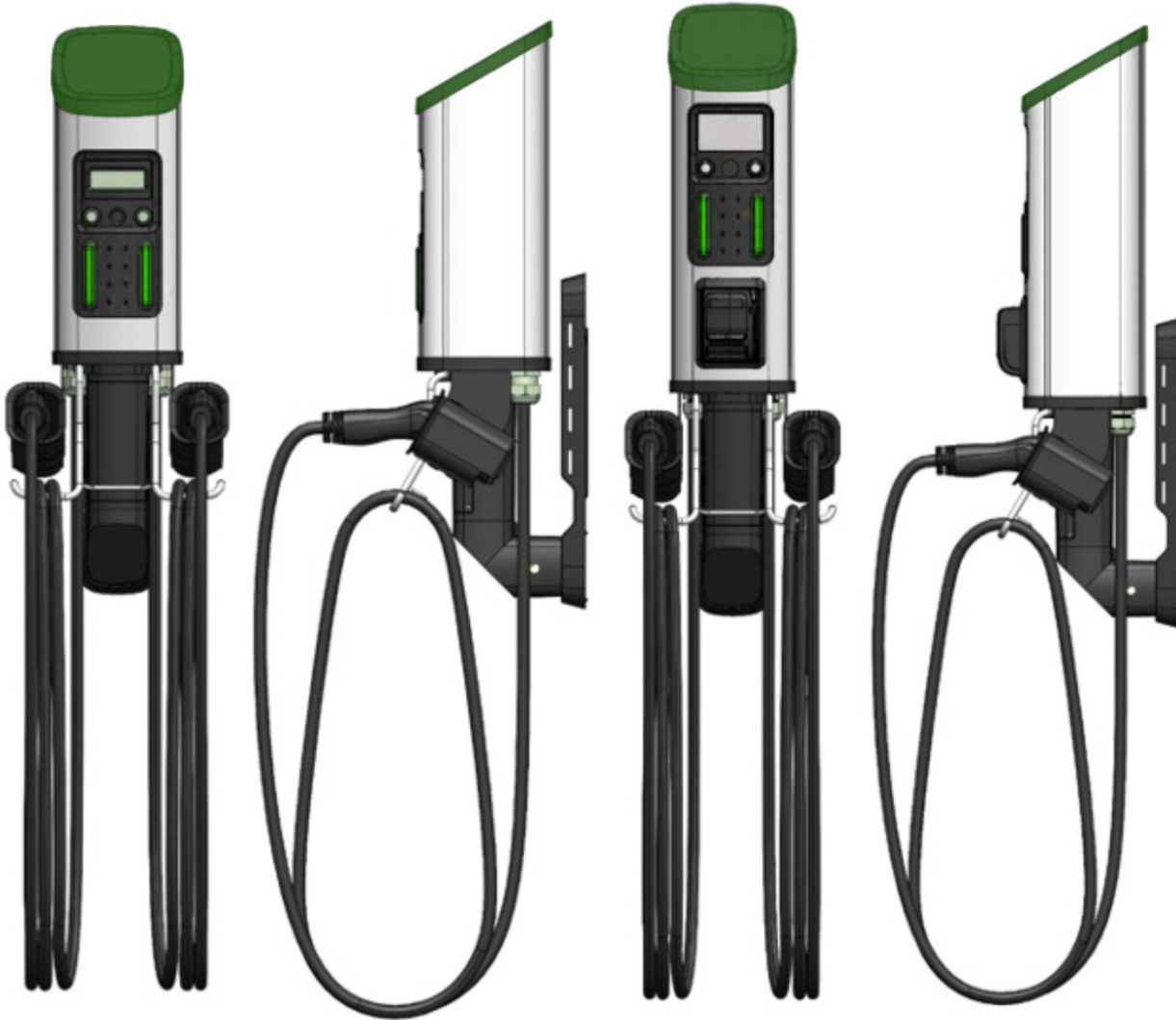

**Series 7/7+**

**Series 8/8+**

*Wall Mount Inventory Specification*

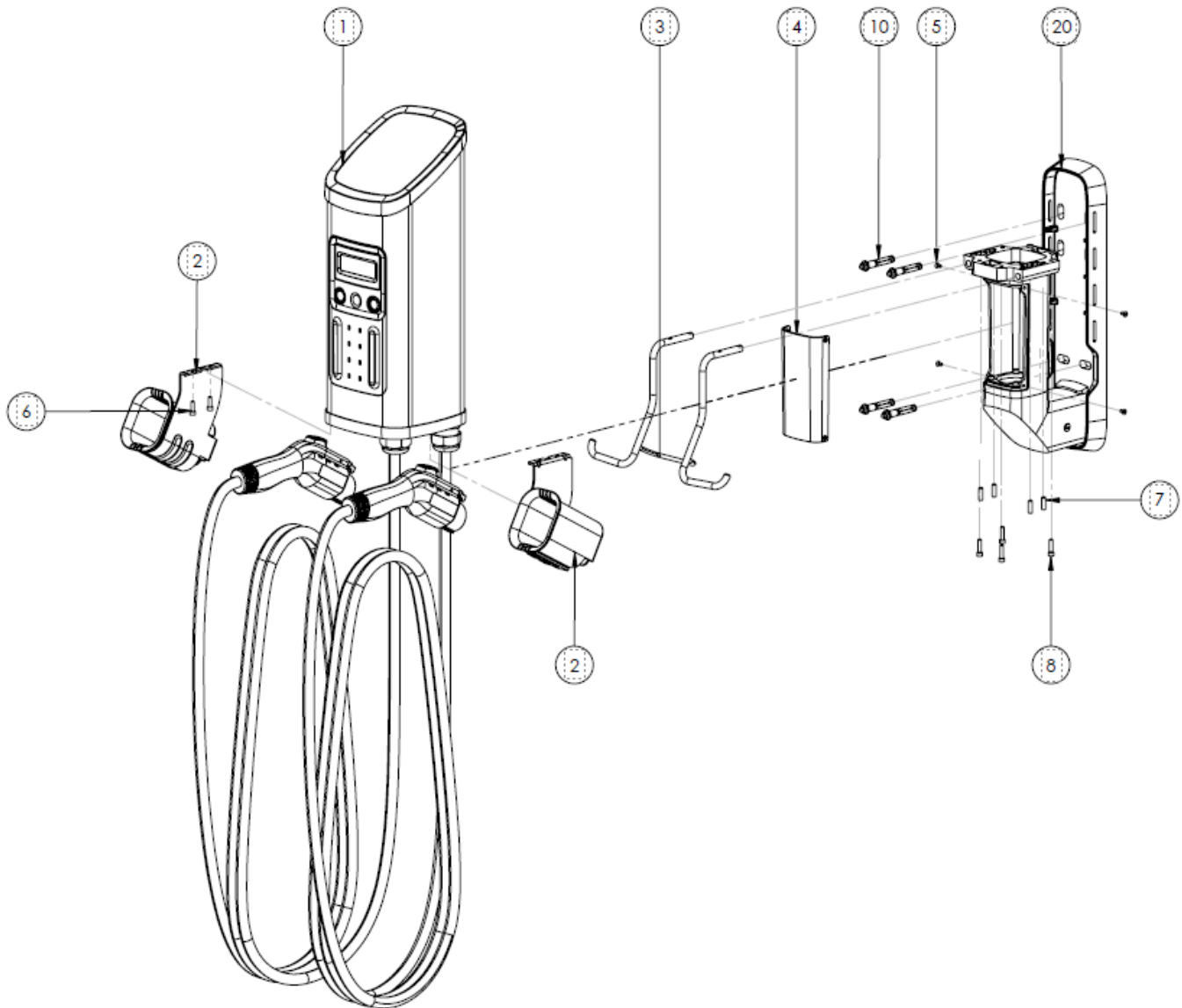

| SL. NO | DESCRIPTION                             | QTY | TOOL REQUIRED            |
|--------|---|-----|--------------------------|
| 01     | HEAD UNIT ASSEMBLY                      | 01  | -                        |
| 02     | HOLSTER ASSEMBLY                        | 02  | -                        |
| 03     | CABLE RACK                              | 01  | -                        |
| 04     | ACCESS PANEL COVER                      | 01  | -                        |
| 05     | ACCESS PANEL SCREWS - M4 X 10mm         | 04  | 2.5mm ALLEN KEY          |
| 06     | HOLSTER MOUNTING SCREWS - M5 X 10mm     | 04  | 4mm X 8" SHANK ALLEN KEY |
| 07     | CABLE RACK SCREWS - M4 X 6mm            | 04  | 2mm ALLEN KEY            |
| 08     | HEAD UNIT MOUNTING SCREWS - M5 X 20mm   | 04  | 4mm ALLEN KEY            |
| 10     | WALL MOUNT ANCHORS (PROVIDED BY OTHERS) | -   | -                        |
| 20     | WALL MOUNT ASSEMBLY                     | 01  | -                        |

## 1. REMOVE ACCESS PANEL AND INSTALL WALL MOUNT ASSEMBLY

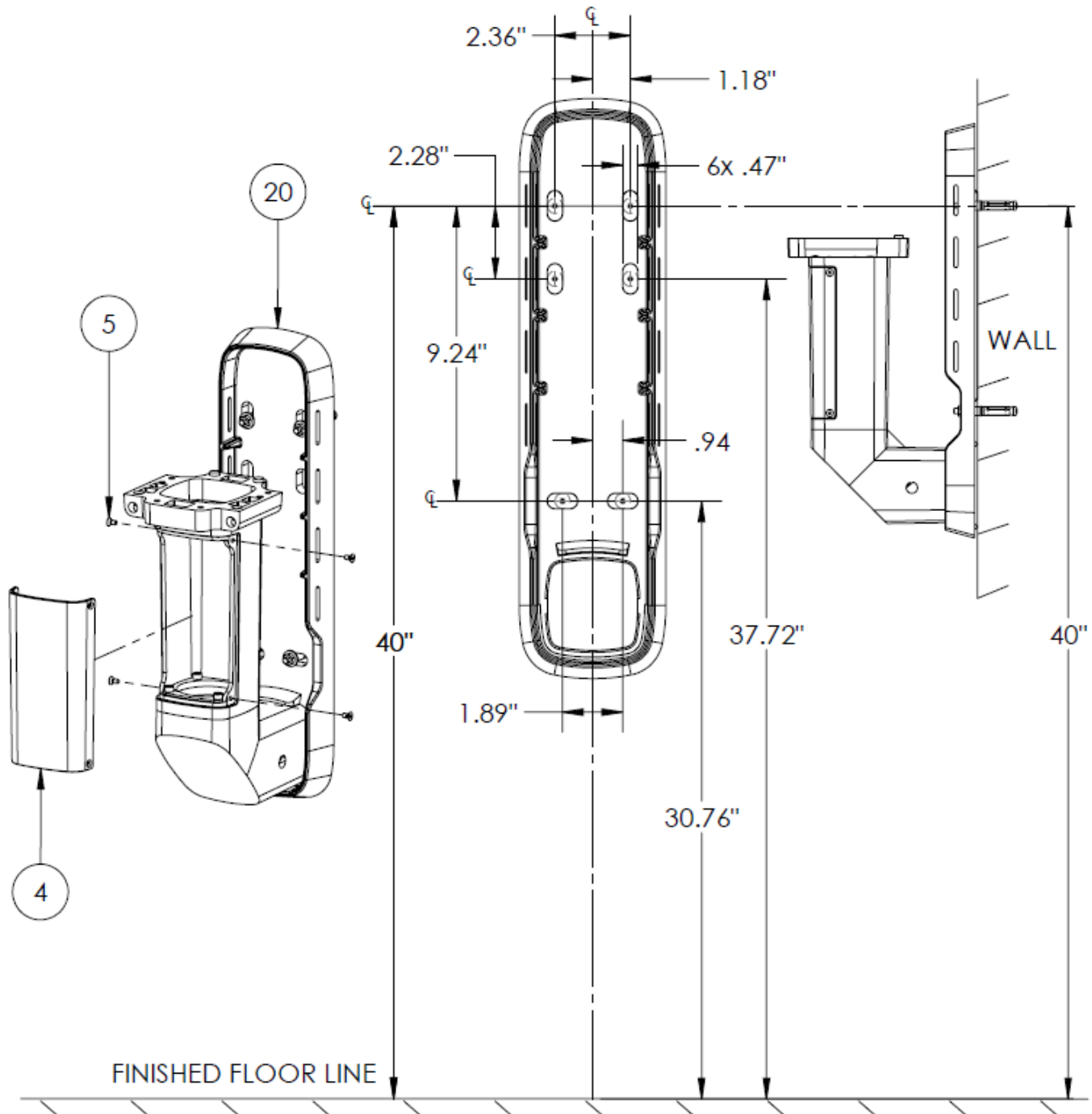

| SL. NO | DESCRIPTION                     | QTY | TOOL REQUIRED   |
|--------|---------------------------------|-----|-----------------|
| 04     | ACCESS PANEL COVER              | 01  | -               |
| 05     | ACCESS PANEL SCREWS - M4 X 10mm | 04  | 2.5mm ALLEN KEY |
| 20     | WALL MOUNT ASSEMBLY             | 01  | -               |



## 2. CONNECT CONDUIT TO WALL MOUNT ASSEMBLY

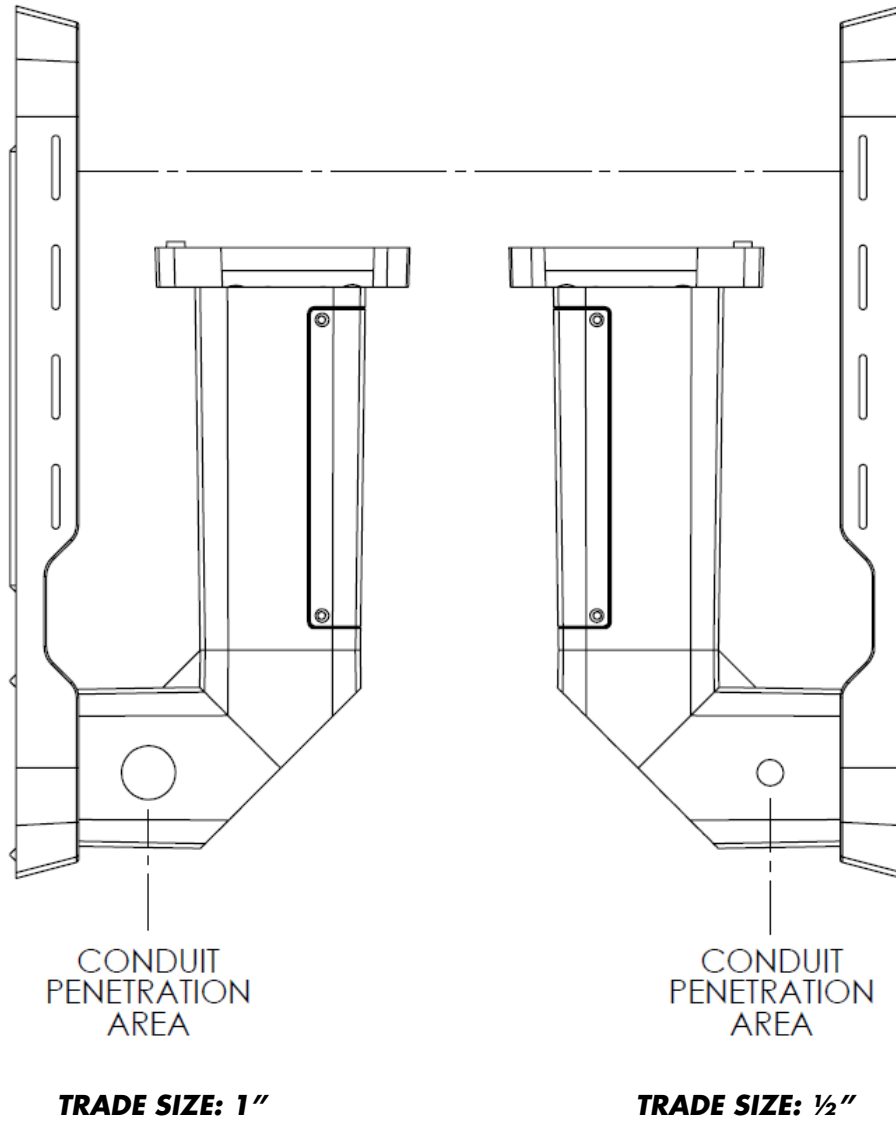

### 3. INSTALL CHARGING HEAD UNIT

## ⚠ CAUTION

Refer to General Requirements section for station weights

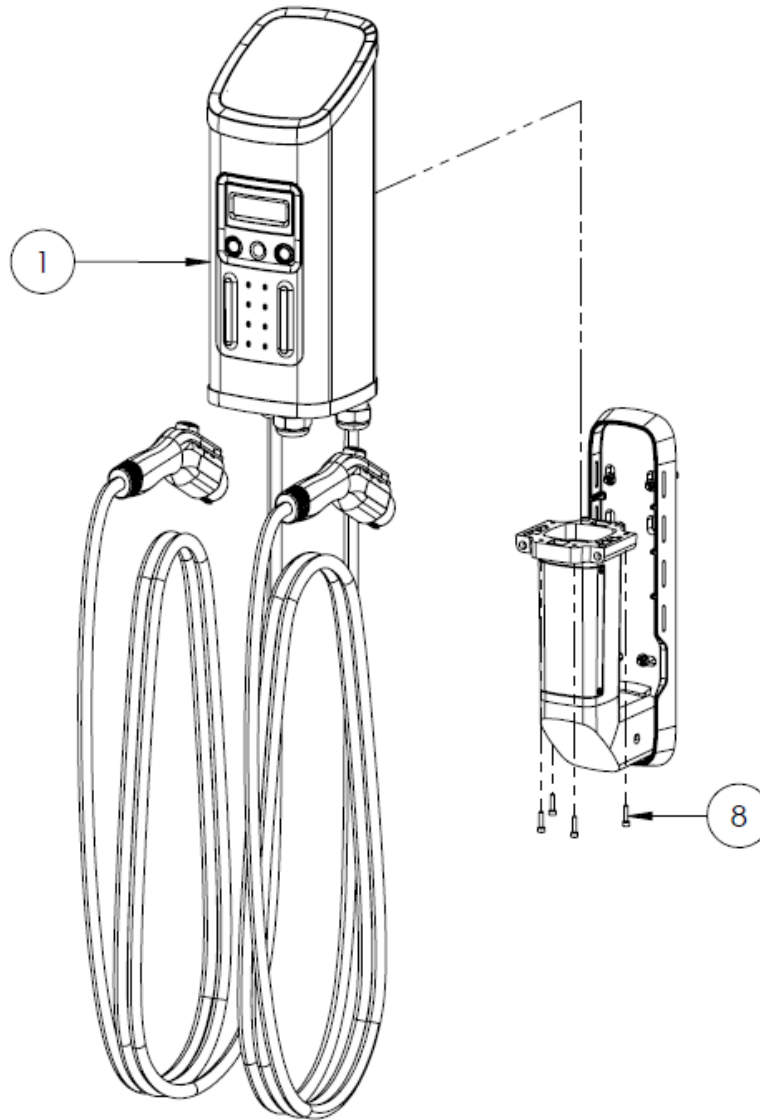

| SL. NO | DESCRIPTION                           | QTY | TOOL REQUIRED |
|--------|---------------------------------------|-----|---------------|
| 01     | HEAD UNIT ASSEMBLY                    | 01  | -             |
| 08     | HEAD UNIT MOUNTING SCREWS - M5 X 20mm | 04  | 4mm ALLEN KEY |

## ⚠ WARNING

**VERIFY ALL CONDUCTORS ARE DE-ENERGIZED. COMPLETE ALL ELECTRICAL CONNECTIONS PRIOR TO STEP 4. SEE SYSTEM REQUIREMENTS SECTION FOR CONNECTION DETAILS.**

RE-INSTALL ACCESS PANEL COVER UPON COMPLETION OF ELECTRICAL CONNECTIONS.

## 4. INSTALL CABLE RACK

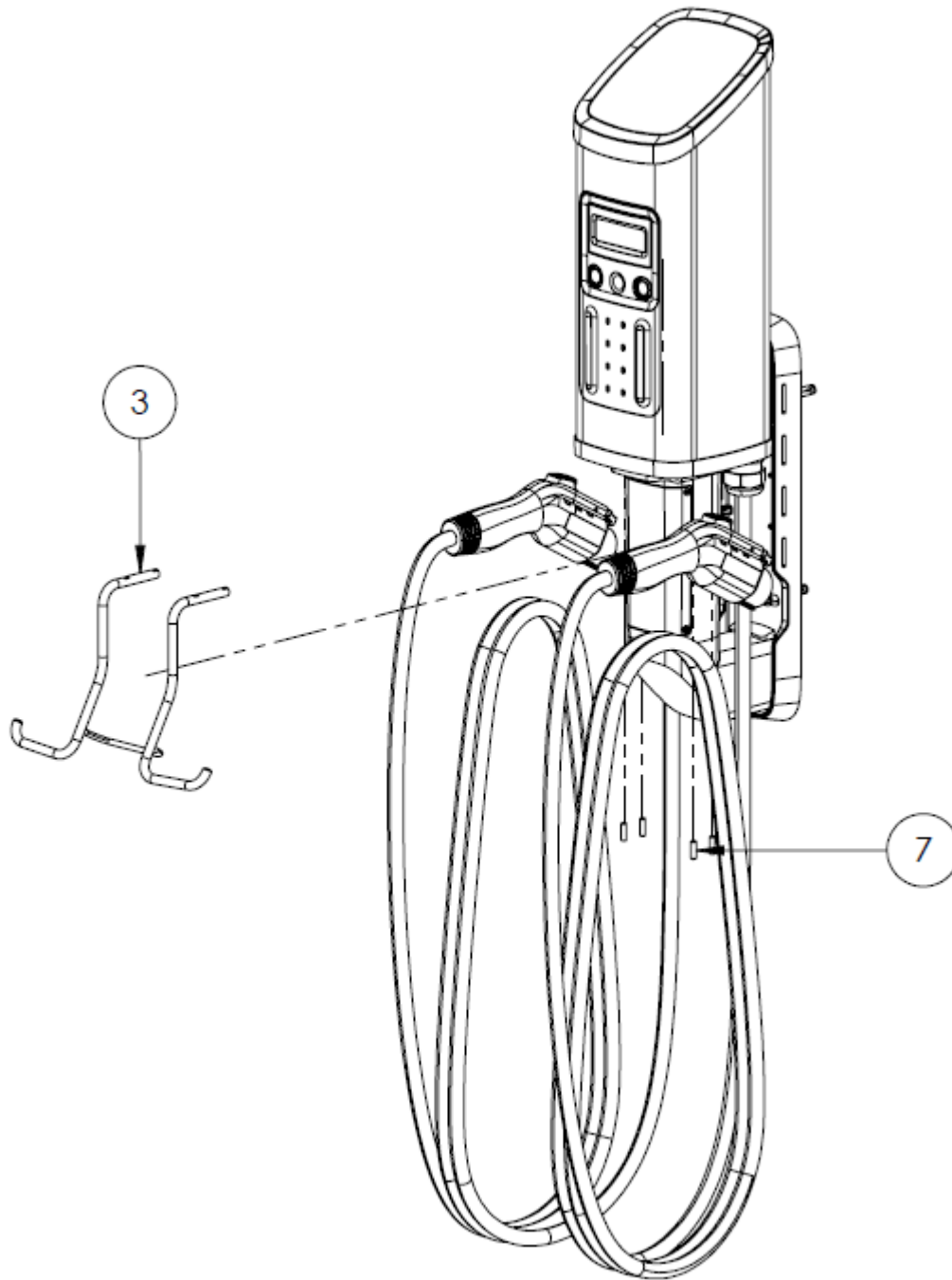

| SL. NO | DESCRIPTION                  | QTY | TOOL REQUIRED |
|--------|------------------------------|-----|---------------|
| 03     | CABLE RACK                   | 01  | -             |
| 07     | CABLE RACK SCREWS - M4 X 6mm | 04  | 2mm ALLEN KEY |

## 5. INSTALL CABLE HOLSTERS

**Note: A 8" (200 MM) SHANK, 4 MM ALLEN WRENCH IS REQUIRED TO ATTACH THE CABLE HOLSTERS TO THE CHARGING STATION**

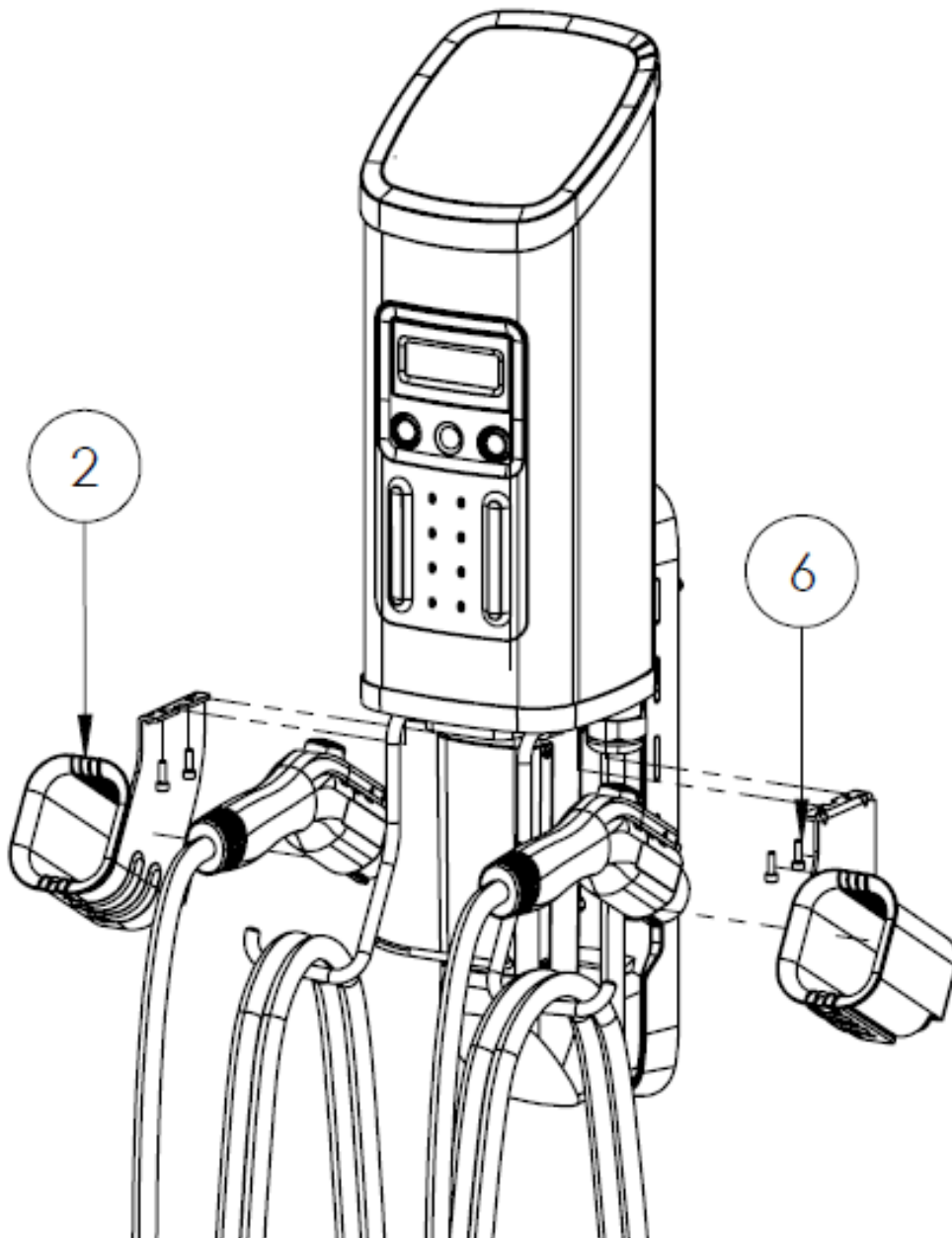

| SL. NO | DESCRIPTION                         | QTY | TOOL REQUIRED            |
|--------|-------------------------------------|-----|--------------------------|
| 02     | HOLSTER ASSEMBLY                    | 02  | -                        |
| 06     | HOLSTER MOUNTING SCREWS - M5 X 10mm | 04  | 4mm X 8" SHANK ALLEN KEY |

## Wall Mount With Cable Management System (CMS)

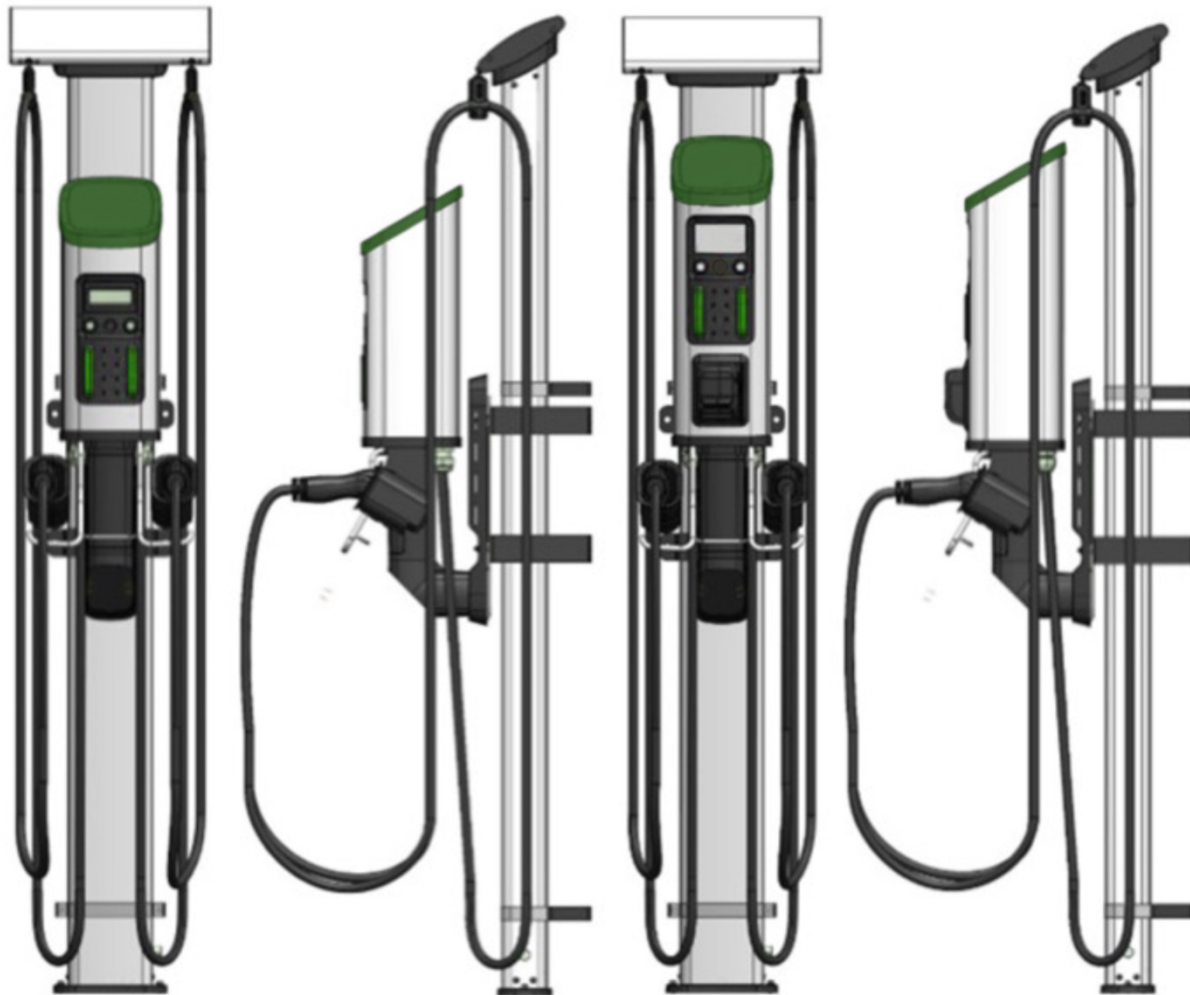

**Series 7/7+**

**Series 8/8+**

---

*WALL MOUNT WITH CABLE MANAGEMENT SYSTEM INVENTORY SPECIFICATION*

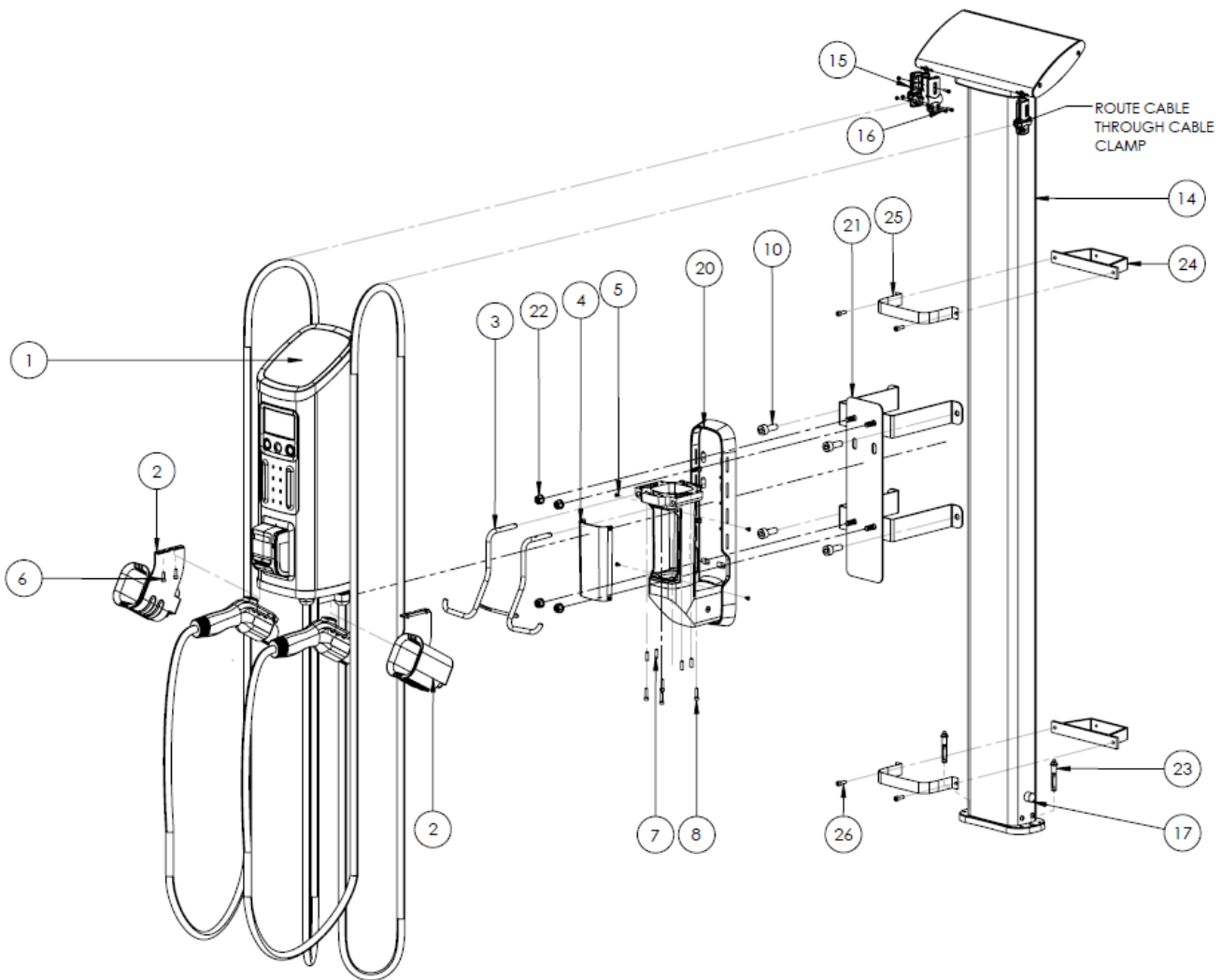

| SL. NO | DESCRIPTION  | QTY | TOOL REQUIRED            |
|--------|--|-----|--------------------------|
| 01     | HEAD UNIT ASSEMBLY   | 01  | -                        |
| 02     | HOLSTER ASSEMBLY   | 02  | -                        |
| 03     | CABLE RACK   | 01  | -                        |
| 04     | ACCESS PANEL COVER   | 01  | -                        |
| 05     | ACCESS PANEL SCREWS - M4 X 10mm                                    | 04  | 2.5mm ALLEN KEY          |
| 06     | HOLSTER MOUNTING SCREWS - M5 X 10mm                                | 04  | 4mm X 8" SHANK ALLEN KEY |
| 07     | CABLE RACK SCREWS - M4 X 6mm                                       | 04  | 2mm ALLEN KEY            |
| 08     | HEAD UNIT MOUNTING SCREWS - M5 X 20mm                              | 04  | 4mm ALLEN KEY            |
| 10     | WALL BRACKET ASSEMBLY ANCHORS (PROVIDED BY OTHERS)                 | -   | -                        |
| 14     | CABLE MANAGEMENT SYSTEM ASSEMBLY                                   | 01  | -                        |
| 15     | OUTPUT CABLE CLAMPS  | 02  | -                        |
| 16     | OUTPUT CABLE CLAMP SCREWS - M4 X 10mm, M4 X 16mm, M4 X 20mm        | 02  | 3mm ALLEN KEY            |
| 17     | CABLE MANAGEMENT SYSTEM COUNTER WEIGHT RETENSION BOLTS - M6 X 30mm | 02  | 5mm ALLEN KEY            |
| 20     | WALL MOUNT ASSEMBLY  | 01  | -                        |
| 21     | WALL MOUNT BRACKET ASSEMBLY  | 01  | -                        |
| 22     | WALL MOUNT BRACKET ASSEMBLY HEX NUT - M10                          | 04  | 10mm SOCKET              |
| 23     | CMS FLOOR ANCHORS (PROVIDED BY OTHERS)                             | -   | -                        |
| 24     | CABLE MANAGEMENT SYSTEM WALL SUPPORT                               | 02  | -                        |
| 25     | CABLE MANAGEMENT SYSTEM WALL SUPPORT STRAPS                        | 02  | -                        |
| 26     | CABLE MANAGEMENT SYSTEM SUPPORT STRAP BOLTS - M6 X 12mm            | 04  | 5mm ALLEN KEY            |

**1. USING THE DRAWING BELOW, MARK ALL AND DRILL ALL ANCHOR CENTERS FOR CMS SUPPORT BRACKETS AND WALL MOUNT BRACKET ASSEMBLY**

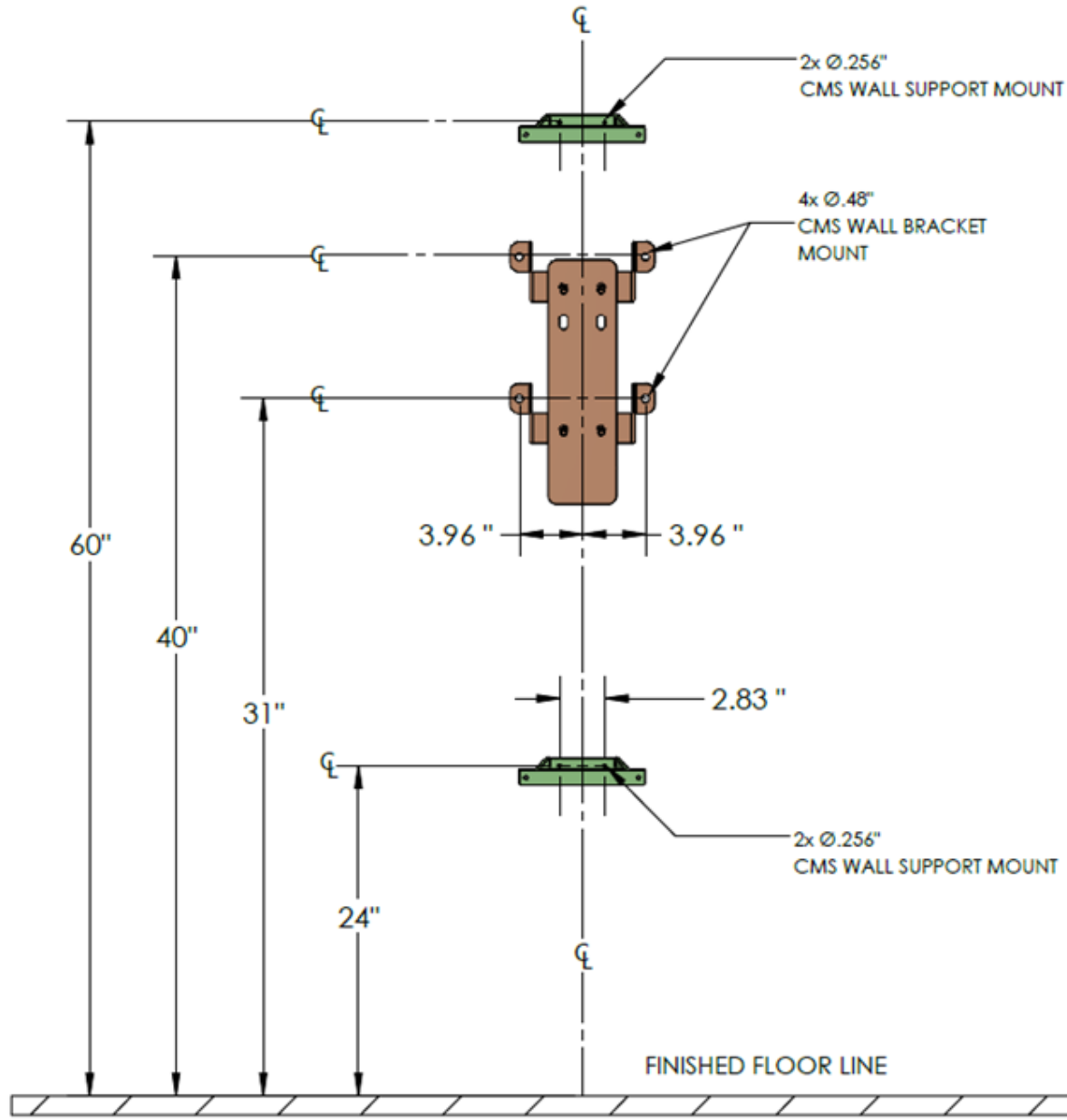

## 2. MOUNT AND SECURE CMS BRACKETS TO WALL

Max Anchor Size = Ø 0.236"

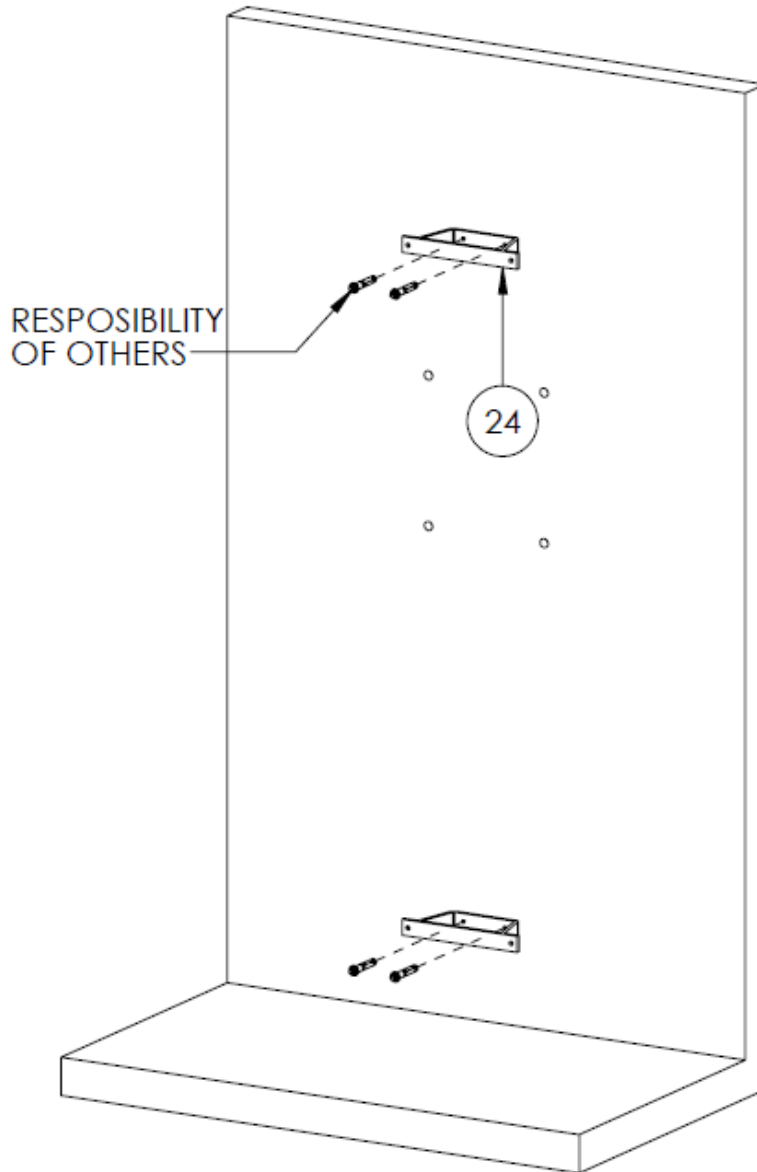

| SL. NO | DESCRIPTION                          | QTY | TOOL REQUIRED |
|--------|--------------------------------------|-----|---------------|
| 24     | CABLE MANAGEMENT SYSTEM WALL SUPPORT | 02  | -             |



### 3. MOUNT AND SECURE CMS TO CMS BRACKETS AND TO FLOOR

#### **CAUTION**

Refer to General Requirements section for Cable Management System Weights  
 Max Anchor Size = Ø 0.236"

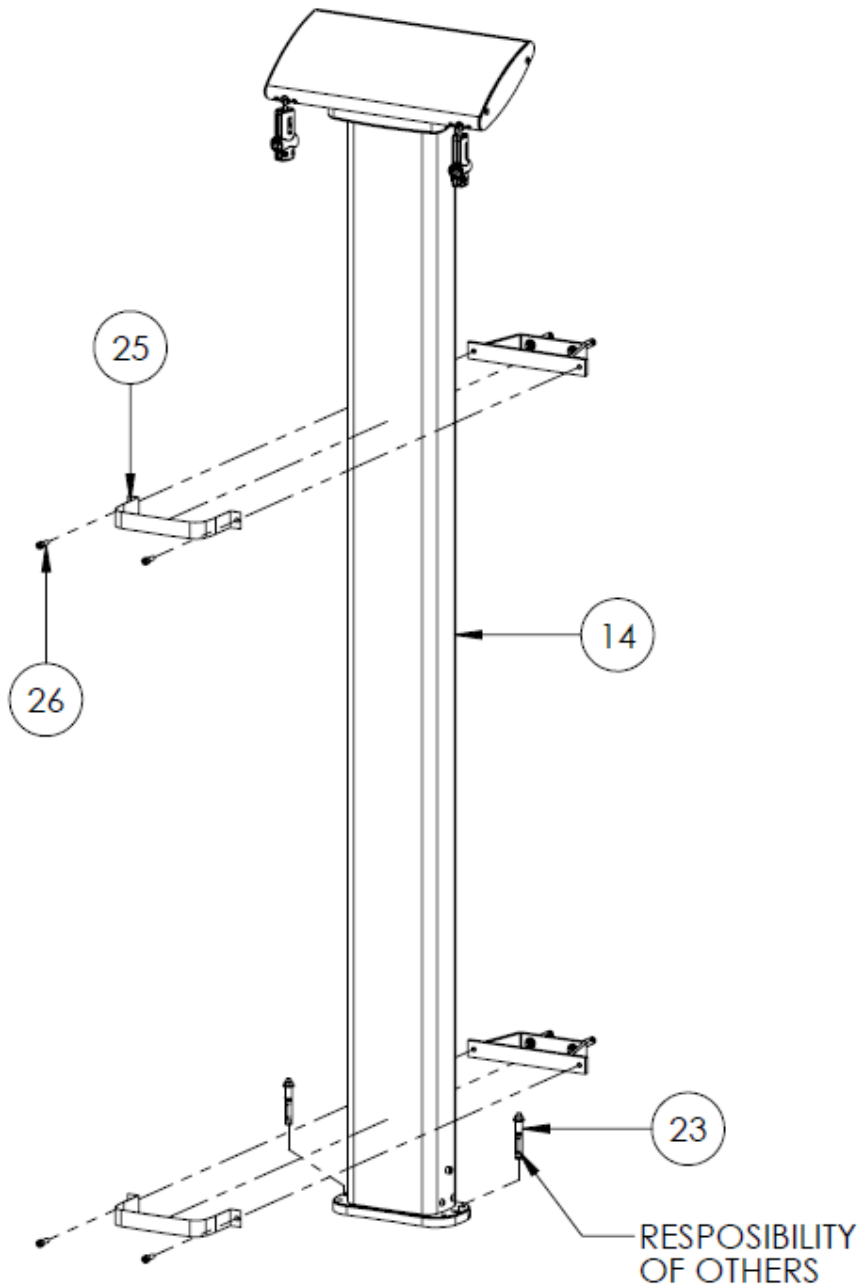

| SL. NO | DESCRIPTION   | QTY | TOOL REQUIRED |
|--------|---|-----|---------------|
| 14     | CABLE MANAGEMENT SYSTEM ASSEMBLY                        | 01  |               |
| 23     | CMS FLOOR ANCHORS (PROVIDED BY OTHERS)                  | -   | -             |
| 25     | CABLE MANAGEMENT SYSTEM WALL SUPPORT STRAPS             | 02  | -             |
| 26     | CABLE MANAGEMENT SYSTEM SUPPORT STRAP BOLTS - M6 X 12mm | 04  | 5mm ALLEN KEY |

## 4. REMOVE ACCESS PANEL COVER AND INSTALL WALL MOUNT BRACKET ASSEMBLY AND WALL MOUNT ASSEMBLY

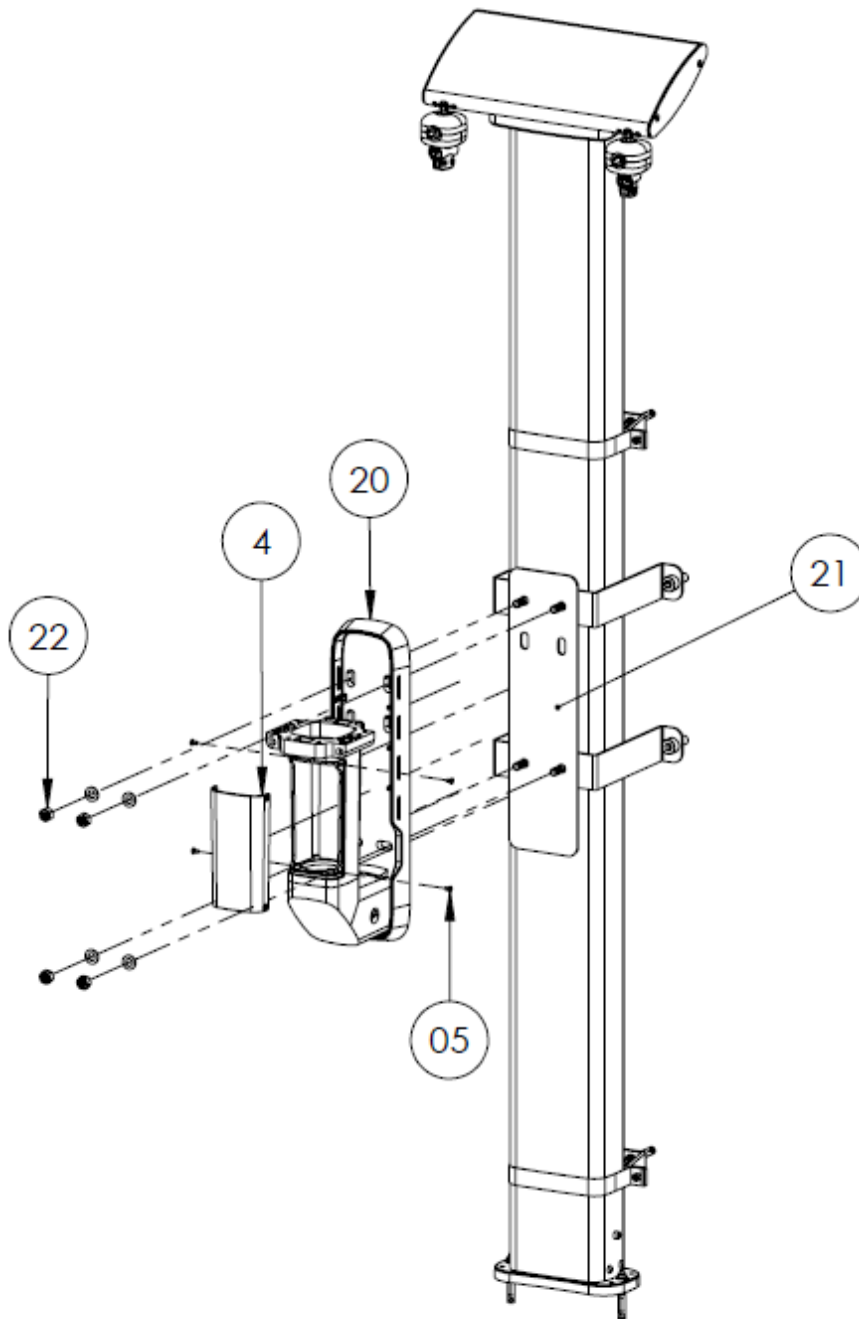

| SL. NO | DESCRIPTION                               | QTY | TOOL REQUIRED   |
|--------|---|-----|-----------------|
| 04     | ACCESS PANEL COVER                        | 01  | -               |
| 05     | ACCESS PANEL SCREWS - M4 X 10mm           | 04  | 2.5mm ALLEN KEY |
| 20     | WALL MOUNT ASSEMBLY                       | 01  | -               |
| 21     | WALL MOUNT BRACKET ASSEMBLY               | 01  | -               |
| 22     | WALL MOUNT BRACKET ASSEMBLY HEX NUT - M10 | 04  | 10mm SOCKET     |

## 5. CONNECT CONDUIT TO WALL MOUNT ASSEMBLY

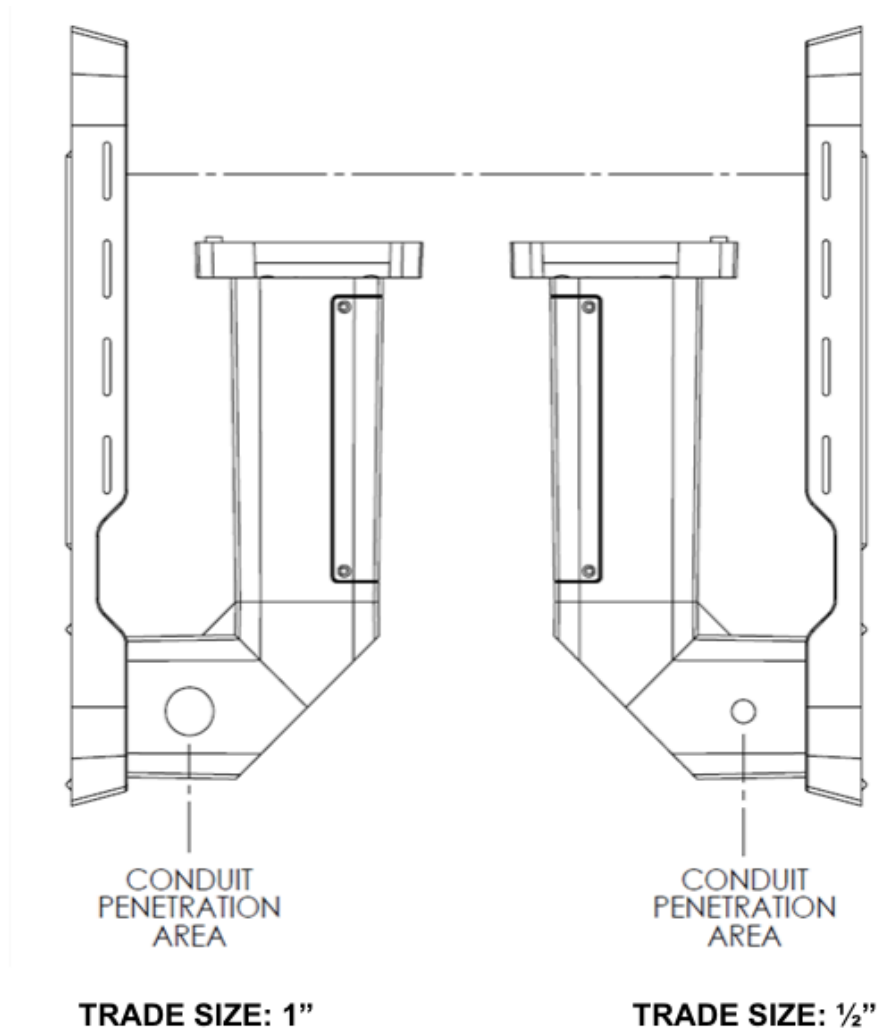

## 6. INSTALL CHARGING HEAD UNIT

### **⚠ CAUTION**

Refer to General Requirements section for station weights

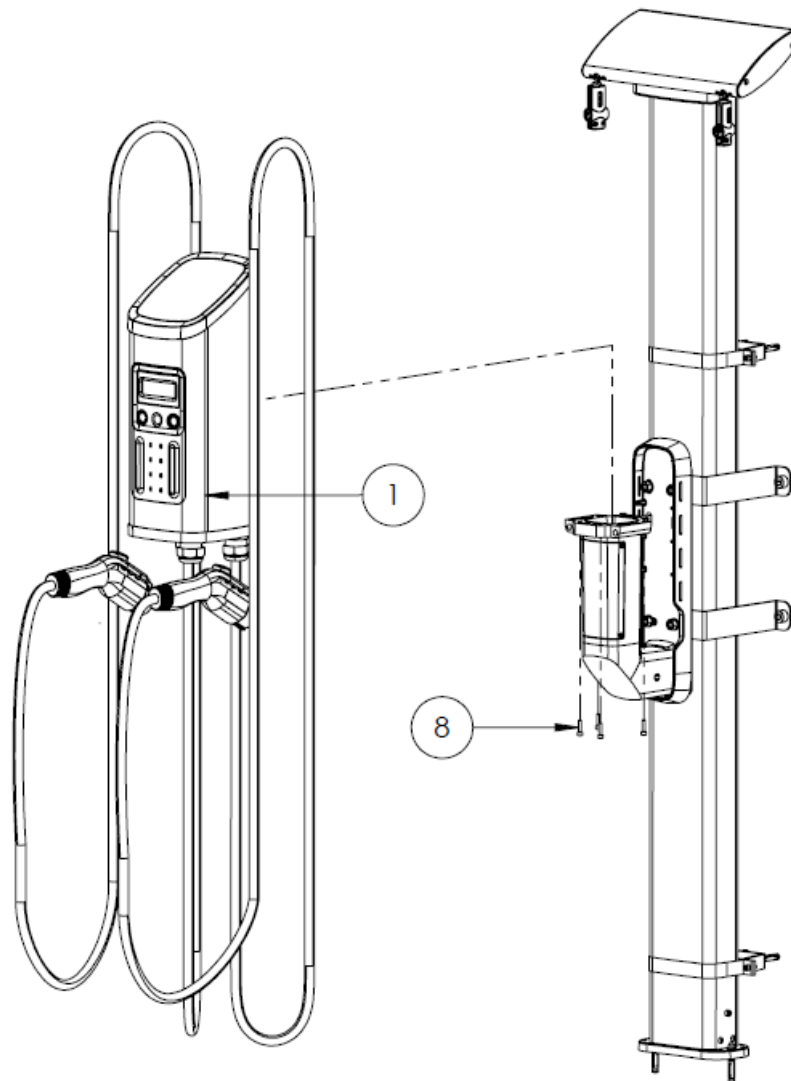

| SL. NO | DESCRIPTION                           | QTY | TOOL REQUIRED |
|--------|---------------------------------------|-----|---------------|
| 01     | HEAD UNIT ASSEMBLY                    | 01  | -             |
| 08     | HEAD UNIT MOUNTING SCREWS - M5 X 20mm | 04  | 4mm ALLEN KEY |

### **⚠ WARNING**

**VERIFY ALL CONDUCTORS ARE DE-ENERGIZED. COMPLETE ALL ELECTRICAL CONNECTIONS PRIOR TO STEP 4. SEE SYSTEM REQUIREMENTS SECTION FOR CONNECTION DETAILS.**

RE-INSTALL ACCESS PLATE COVER UPON COMPLETION OF ELECTRICAL CONNECTIONS.

## 7. INSTALL CABLE RACK (CABLE RACK OPTIONAL WITH CMS)

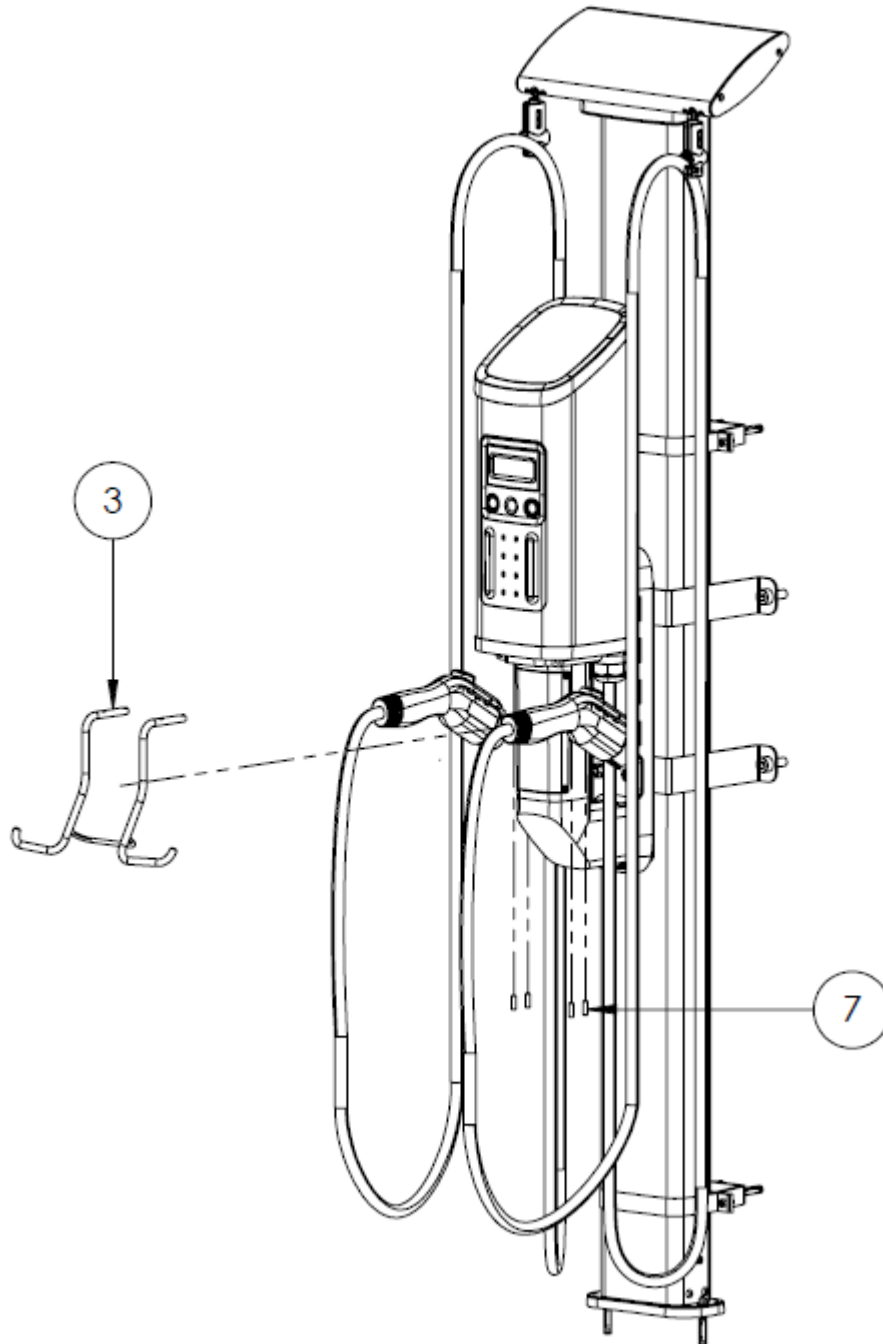

| SL. NO | DESCRIPTION                  | QTY | TOOL REQUIRED |
|--------|------------------------------|-----|---------------|
| 03     | CABLE RACK                   | 01  | -             |
| 07     | CABLE RACK SCREWS - M4 X 6mm | 04  | 2mm ALLEN KEY |

## 8. INSTALL CABLE HOLSTERS

**Note: A 8" (200 MM) SHANK, 4 MM ALLEN WRENCH IS REQUIRED TO ATTACH THE CABLE HOLSTERS TO THE CHARGING STATION**

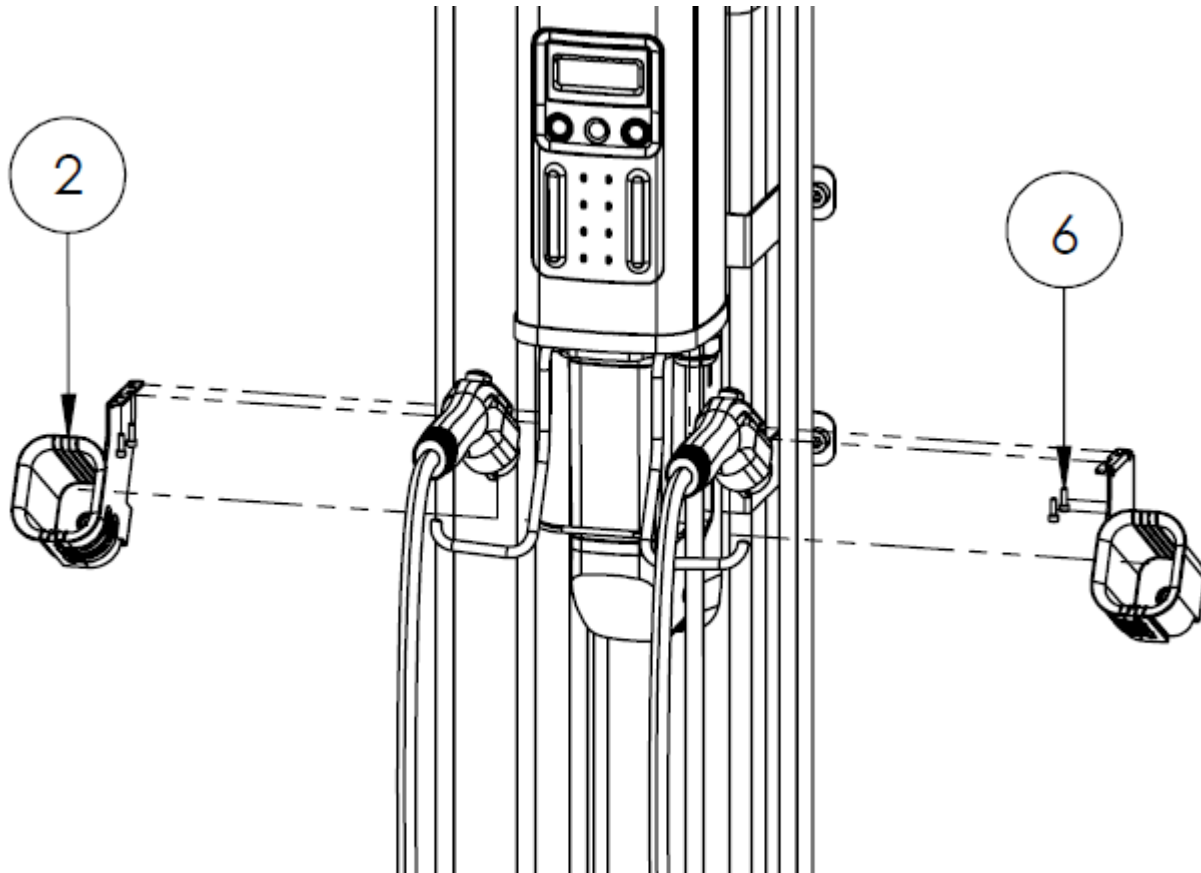

| SL. NO | DESCRIPTION                         | QTY | TOOL REQUIRED            |
|--------|-------------------------------------|-----|--------------------------|
| 02     | HOLSTER ASSEMBLY                    | 02  | -                        |
| 06     | HOLSTER MOUNTING SCREWS - M5 X 10mm | 04  | 4mm X 8" SHANK ALLEN KEY |

## 9. INSTALL CABLE MANAGEMENT SYSTEM OUTPUT CABLE CLAMPS

### 30A/48A Cable Clamp

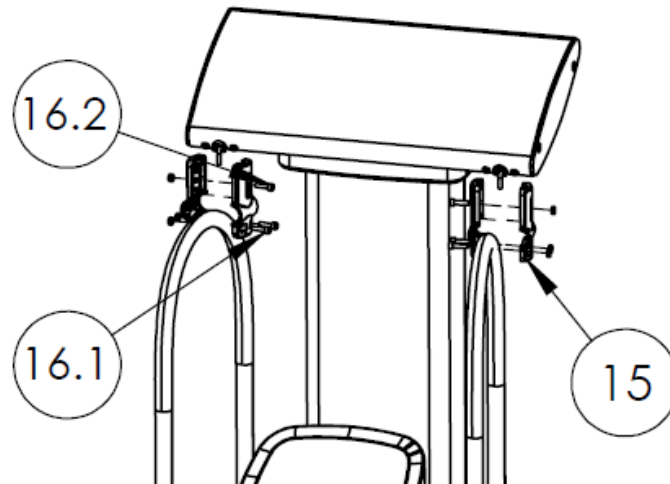

### 80A Cable Clamp

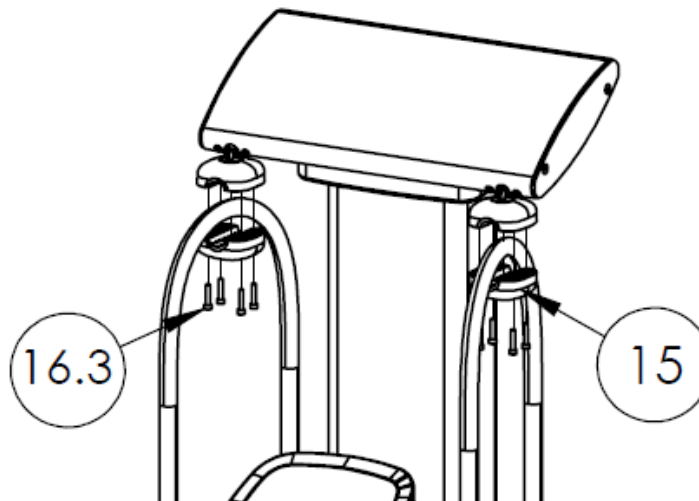

18' Cable – Install clamp 9' from the output cable J1772 coupler

25' Cable – Install clamp 9' from the output cable J1772 coupler

| SL. NO | DESCRIPTION                           | QTY | TOOL REQUIRED |
|--------|---------------------------------------|-----|---------------|
| 15     | OUTPUT CABLE CLAMPS                   | 02  | -             |
| 16.1   | OUTPUT CABLE CLAMP SCREWS - M4 X 10mm | 04  | 3mm ALLEN KEY |
| 16.2   | OUTPUT CABLE CLAMP SCREWS - M4 X 16mm | 02  | 3mm ALLEN KEY |
| 16.3   | OUTPUT CABLE CLAMP SCREWS - M4 X 20mm | 08  | 3mm ALLEN KEY |

## 10. REMOVE CABLE MANAGEMENT SYSTEM (CMS) COUNTERWEIGHT RETENTION BOLTS

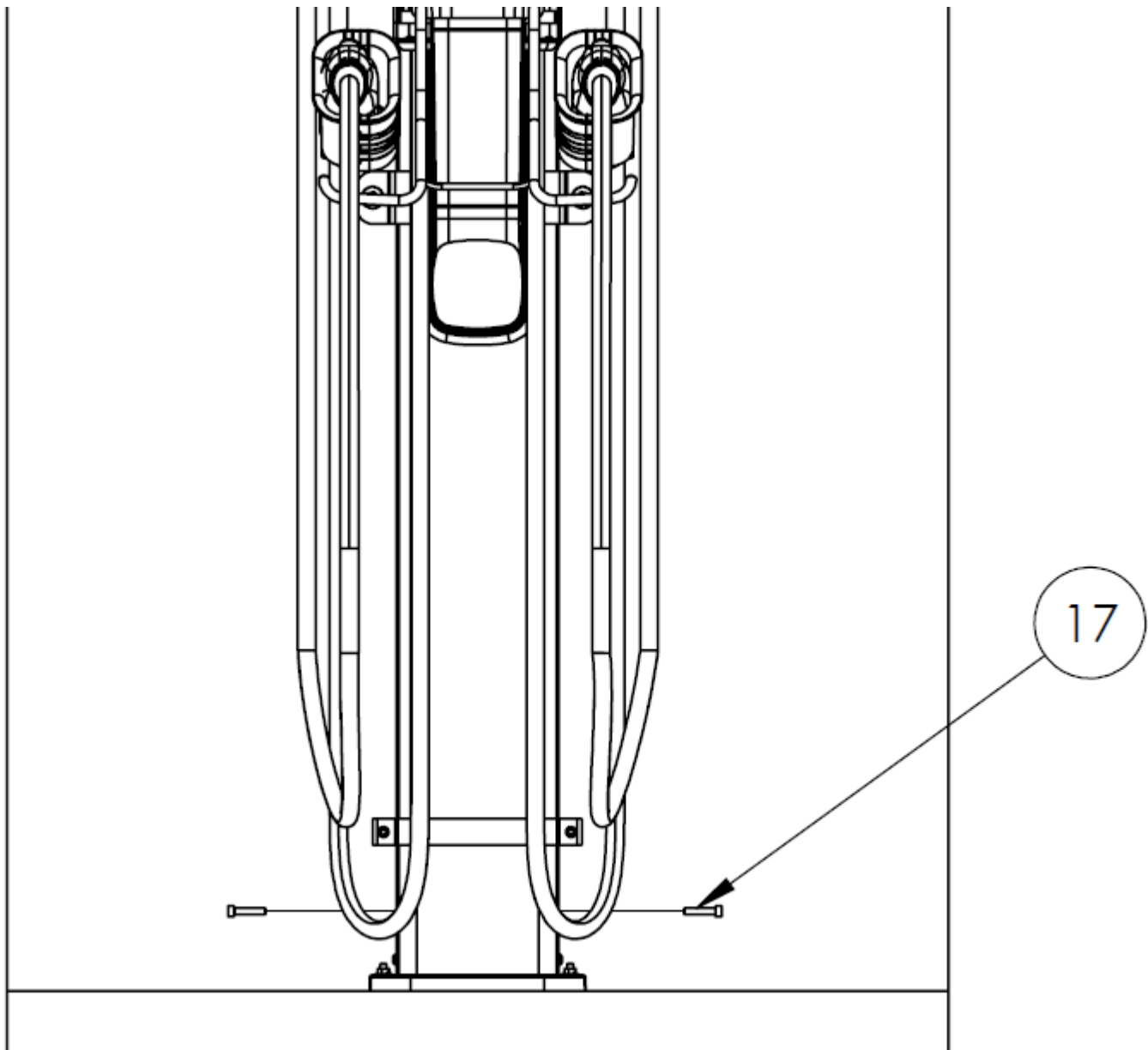

| SL. NO | DESCRIPTION  | QTY | TOOL REQUIRED |
|--------|--|-----|---------------|
| 17     | CABLE MANAGEMENT SYSTEM COUNTER WEIGHT RETENSION BOLTS - M6 X 30mm | 02  | 5mm ALLEN KEY |



## START-UP

### 1. STATION REGISTRATION

#### NOTICE

Once your stations have been installed and prior to initial energization, **please contact Customer Service at +1 888 998 2546 or [Support@blinknetwork.com](mailto:Support@blinknetwork.com) to complete station enrollment.**

If modified output configurations are needed, please provide the following information for each station:

- Panel voltage: **(Example - 120/208V or 120/240V)**
- Circuit numbers & amperage feeding the charging stations: **(Example - CKT 37/39 2 Pole 60A)**
- Serial Numbers connected to each circuit number: **(Example: BAE\*\*\*\*\* Circuit 37/39)**

If load management is needed, please provide the following information for each station:

- Panel(s) name: **(Example - PNL1B)**
- Panel(s) voltage & amperage: **(Example - 120/208V 225A)**
- Circuit numbers & amperage feeding the charging stations: **(Example - CKT 37/39 2 Pole 100A)**
- Serial Numbers connected to each circuit number: **(Example: BAE\*\*\*\*\* Circuit 37/39)**

### 2. ENERGIZATION AND TROUBLE SHOOTING

#### NOTICE

After installation, station registration, and load management and/or modified output configurations have been completed (if applicable) the Blink station is ready to be energized. After energizing the station, both at-a-glance LED lights should illuminate BLUE. If both station at-a-glance LED lights do not illuminate BLUE, please refer to the following troubleshooting guidance:

- No LED lights or LCD screen: Voltage not present. Verify proper wiring, voltage, and circuit breaker(s) status
- Both LED lights RED, LCD screen displays, "Customer Service 1-800-663-5633": Station registration needs to be completed
- Both LED lights RED, LCD screen displays, "GF 0800": Grounding problem. Check/verify solidly grounded electrical system integrity
- One LED light RED, one LED light BLUE, LCD screen displays, "GF 0100" or "GF0900": Voltage is not present to side of station illuminated RED. Verify proper wiring, voltage, and circuit breaker(s) status
- Both LED lights PURPLE, LCD screen displays, "Station Offline, Limited Access": Station not communicating with Blink Network platform due to inadequate cellular signal

Please contact Blink Customer Service at **+1 888 998 2546** for any questions or issues not listed.

### 3. HOUSEKEEPING

#### **⚠️ WARNING**

Blink EV charging stations may be cleaned in accordance with the following guidance:

- Use clean, soft cloth along with mild detergent to wash the dirt off
- Pour water gently from the top and use a wet/dry cloth to clean all the sides
- **Do not use excessive water pressure**
- **Do not use strong detergents or any other chemicals (acids, petrol, thinner, or any other solvent)**
- **Avoid exerting excessive pressure on the device while cleaning**
- **Do not open the device**
- **Do not use a vacuum cleaner**

## OFFEROR'S CHECKLIST

*NOTE: These items are the criteria on which your proposal will be evaluated.*

Please make sure that the following items are included with your submittal:

- ❑ Submittal Form (**Required**)
- ❑ Non-Collusion Oath (**Required**)
- ❑ Documentation of Insurance Coverage (**Required**)
- ❑ Copy of Business License (If applicable)
- ❑ Minority/Women-Owned Business Certification (Preferred but not required)

**NOTE: IN ADDITION TO THE ABOVE, THE FOLLOWING ITEMS MUST ALSO BE INCLUDED OR ADDRESSED IN YOUR SUBMITTAL:**

- ❑ Organization Information (**Required**)
- ❑ Personnel List (i.e., names of persons to be used in this engagement) (**Required**)
- ❑ References (**Required**)
- ❑ All-Inclusive Cost (**Required**)

***You do not have to submit the Offeror's Checklist. This list is included for your convenience. However, all required information must be provided.***

***Failure to submit the required items may deem your submittal to be non-responsive.***

**SUBMITTAL FORM**

**(Offeror to complete all blanks)**

**Page One**

Date: \_\_\_\_\_, 2024

**ORGANIZATIONAL INFORMATION**

NAME OF OFFEROR: \_\_\_\_\_

BUSINESS ADDRESS: \_\_\_\_\_

\_\_\_\_\_

**BY SUBMITTING THIS PROPOSAL, THE UNDERSIGNED OFFEROR REPRESENTS:**

1. The offeror has carefully examined the specifications for the Services;
2. The offeror is familiar with all the conditions surrounding the performance of the Services;
3. If awarded the Contract, the offeror will provide all labor, material, supplies, and equipment necessary to execute the Services in accordance with the Contract Documents;
4. understands the Town reserves the right to reject any or all responses that do not meet the proposal requirements or all proposals in the event the Project is canceled, postponed, or if it is in the best interest of the Town of Kiawah Island;
5. If awarded the Contract, will enter and execute a contract as required in the Invitation to Bid;
6. The Offeror is legally able to enter into and perform a contract if awarded;
7. The Offeror is current on all taxes and fees owed to the Town;
8. The Offeror has provided proof of insurance as required by the Town.

**I. PERSONNEL:**

Provide a list of personnel that will be committed to this engagement and their job function.

---

---

---

---

---

---

---

---

---

---

---

---

---

---

---

---

---

---

---

---

---

---

---

**II. REFERENCES / EXPERIENCE:**

**At least three (3) references for similar work performed are required; however, you may provide as many as five (5) references.**

1. **COMPANY NAME:** \_\_\_\_\_

Contract Title \_\_\_\_\_

Contract Period: From \_\_\_\_\_ To \_\_\_\_\_

Geographic Area Served \_\_\_\_\_

Scope of Work: \_\_\_\_\_

Contracting Office: \_\_\_\_\_

Contact Name: \_\_\_\_\_

Title: \_\_\_\_\_

Address: \_\_\_\_\_

City \_\_\_\_\_ State: \_\_\_\_\_

Telephone: \_\_\_\_\_

Email: \_\_\_\_\_

**REFERENCES / EXPERIENCE (Continued):**

2. **COMPANY NAME:** \_\_\_\_\_  
Contract Title \_\_\_\_\_  
Contract Period: From \_\_\_\_\_ To \_\_\_\_\_  
Geographic Area Served \_\_\_\_\_  
Scope of Work: \_\_\_\_\_  
Contracting Office: \_\_\_\_\_  
Contact Name: \_\_\_\_\_  
Title: \_\_\_\_\_  
Address: \_\_\_\_\_  
City \_\_\_\_\_ State: \_\_\_\_\_  
Telephone: \_\_\_\_\_  
Email: \_\_\_\_\_

3. **COMPANY NAME:** \_\_\_\_\_  
Contract Title \_\_\_\_\_  
Contract Period: From \_\_\_\_\_ To \_\_\_\_\_  
Geographic Area Served \_\_\_\_\_  
Scope of Work: \_\_\_\_\_  
Contracting Office: \_\_\_\_\_  
Contact Name: \_\_\_\_\_  
Title: \_\_\_\_\_  
Address: \_\_\_\_\_  
City \_\_\_\_\_ State: \_\_\_\_\_  
Telephone: \_\_\_\_\_  
Email: \_\_\_\_\_

**III. COST:**

In compliance with the Request for Proposals, the undersigned hereby proposes to provide all permits, materials, equipment, and labor, except as otherwise provided noted, to expand the asphalt at the end of the employee lot to include curb and gutter and to install the provided EV charging stations for the following cost:

| <i>Total Proposed Cost</i> |
|----------------------------|
| \$                         |

**NAME OF COMPANY:** \_\_\_\_\_

By: \_\_\_\_\_  
Signature Print Name

Title: \_\_\_\_\_ (i.e., Owner, Partner, Corporate Officer, etc.)

Address: \_\_\_\_\_

City: \_\_\_\_\_ State: \_\_\_\_\_ Zip: \_\_\_\_\_

Telephone Number: \_\_\_\_\_ Business Fax Number: \_\_\_\_\_

Is your firm a \_\_\_\_\_ Corporation, \_\_\_\_\_ Sole Proprietorship, or \_\_\_\_\_ Partnership?

If incorporated, please list the state of incorporation: \_\_\_\_\_

FEIN or SSN: \_\_\_\_\_

**BUSINESS LICENSE:**

The Offeror is not required to have valid business licenses to submit a Proposal. However, the Offeror must possess a valid Business License for business undertaken within the corporate limits of the Town of Kiawah Island.

Does your business have a valid **Town of Kiawah Island** Business License?

\_\_\_ Yes \_\_\_ No If yes, list the number \_\_\_\_\_

Contact (843) 768-9166 with any questions. If no, a business license must be obtained upon award of the contract.

**INSURANCE:**

The successful offeror, at his own expense, shall keep in force and at all times maintain the insurance requirements as outlined below during the term of any contract resulting from this RFP.

**GENERAL LIABILITY:** \$1,000,000 combined single limit per occurrence for bodily injury, property damage, and personal injury with a \$2,000,000 general aggregate limit.

**AUTOMOBILE LIABILITY:** \$1,000,000 combined single limit per accident for bodily injury and property damage.

**WORKERS' COMPENSATION:** Statutory limits are required by South Carolina state law, and employers' liability limits are \$100,000 per accident.

The successful offeror shall provide acceptable Insurance Certificate(s) and Endorsement(s) to the Town no later than at the execution of any contract resulting from this RFP. The Town reserves the right to receive any additional documentation or information verifying insurance coverage as the Town deems necessary. The Town may contact the successful offeror's insurance agent(s) or carrier(s) directly concerning any insurance issues.

The Town of Kiawah Island must be advised immediately of any changes in required coverage(s).



**INDEMNIFICATION**

Except for expenses or liabilities arising from the negligence of the Town, the offeror hereby expressly agrees to indemnify and hold the Town of Kiawah Island harmless against any and all expenses and liabilities arising out of performance or default of any resulting contract as follows:

The offeror expressly agrees to the extent that there is a causal relationship between its negligent, reckless, or intentionally wrongful action or inaction or the negligent, reckless, or intentionally wrongful action or inaction of any of its employees or any person, firm, or corporation directly or indirectly employed by the offeror, and any damage, liability, injury, loss or expense (whether in connection with bodily injury or death or property damage or loss) that is suffered by the Town and its employees or any member of the public, to indemnify and save the Town and its employees harmless against any and all liabilities, penalties, demands, claims, lawsuits, losses, damages, costs, and expenses arising out of the performance or default of any resulting contract from this RFP. Such costs are to include any defense, settlement, or reasonable attorneys’ fees incurred by the Town or its employees. This promise to indemnify shall include bodily injuries or death occurring to the offeror’s employees and any person directly or indirectly employed by the offeror (including without limitation any employee of any subcontractor), the Town’s employees, the employees of any other independent contractors, or occurring to any member of the public. When the Town submits notice, the offeror shall promptly defend any aforementioned action. This obligation shall survive the suspension or termination of this Agreement. The limits of insurance coverage required herein shall not serve to limit this obligation to indemnify. The recovery of costs and fees shall extend to those incurred in the enforcement of this indemnity.

**MINORITY/WOMEN-OWNED ENTERPRISE:**

Are you a Minority or Woman-Owned business?  Yes  No

If so, are you certified?  Yes  No

If you are certified, you must furnish a copy of your certificate with your submittal.

# NON-COLLUSION OATH

COUNTY OF: \_\_\_\_\_

STATE OF: \_\_\_\_\_

Before me, the Undersigned, a Notary Public, for and in the County and State aforesaid, personally appeared \_\_\_\_\_ and made oath that the Offeror herein, his agents, servants, and/or employees, to the best of his knowledge and belief, have not in any way colluded with anyone for and on behalf of the Offeror, or themselves, to obtain information that would give the Offeror an unfair advantage over others, nor have they colluded with anyone for and on behalf of the Offeror, or themselves, to gain any favoritism in the award of the contract herein.

SWORN TO BEFORE ME THIS \_\_\_\_\_ DAY OF \_\_\_\_\_, 2024

\_\_\_\_\_  
Authorized Signature for Offeror

Please print the Offeror's name and address:

\_\_\_\_\_  
\_\_\_\_\_  
\_\_\_\_\_

\_\_\_\_\_  
NOTARY PUBLIC FOR THE STATE OF \_\_\_\_\_

My Commission Expires: \_\_\_\_\_

Print Name: \_\_\_\_\_